

**James**  
Products Limited

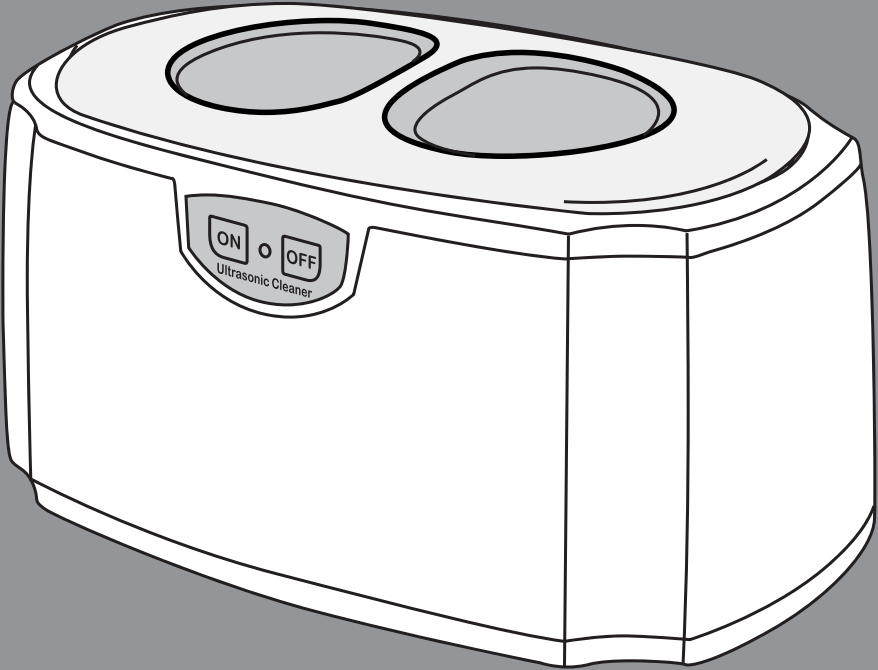

**ULTRA  
2000**

**ULTRASONIC CLEANER**

**USER GUIDE**

## **INTRODUCTION**

Thank you for buying this James Products Ltd ultrasonic cleaner.

Ultrasonic cleaning is a unique phenomenon. Millions of tiny bubbles are created when ultrasonic sound is passed through liquid. It is these tiny bubbles combined with a huge pressure that creates incredible cleaning results.

## **READ THE USER GUIDE**

The Ultra range of ultrasonic cleaners are very easy to use, although to get the best from your new purchase, we recommend you read this User Guide before getting down to any serious cleaning.

It also contains important safety information as well as practical hints.

## **UNPACKING**

Remove your Ultra 2000 cleaner from its packaging and ensure that along with this User Guide you have the correct mains plug fitted for your supply and the specified accessories.

Retain the packing carton for storage of your unit, and also in the unlikely event that the unit needs to be returned for service or repair.

## **IMPORTANT**

This unit is fitted with a 13 Amp (BS 1363) plug with a 3 Amp fuse. When replacing the fuse only a 3A ASTA approved to BS1362 type should be used. Always be sure to re-fit the fuse cover.

In the event that you need to change the plug then the following instructions must be followed :

As the colours of the wires in the mains lead of this appliance may not correspond with the coloured markings identifying the terminals in your plug, proceed as follows:

The wire which is coloured blue must be connected to the terminal which is marked with the letter N or coloured black.

The wire which is coloured brown must be connected to the terminal which is marked with the letter L or coloured red.

No connection is to be made to the earth terminal of the plug.

## INDEX

- 2 Safety Instructions
- 3 Suggested Applications
- 4 Features and Accessories
- 5 Operating Instructions
- 6 Different ways of cleaning
- 7 Removing Carbon, Tarnish & Rust
- 8 Using the Optional Accessories
- 9 Maintenance and Storage
- 9 Specification
- 10 Guarantee

# SAFETY INSTRUCTIONS

READ THIS BEFORE USING YOUR PRODUCT

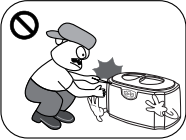

Do not attempt to remove any screws or panels. There are no user serviceable parts inside.

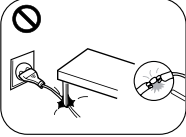

Do not operate this unit if the cord or plug is damaged. Please refer to a service centre for examination and repair.

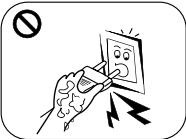

To avoid electric shock never touch the cord or socket with wet hands.



Keep the unit unplugged before filling.  
Do not use boiling water as damage to the unit may occur.  
Do not exceed the "MAX" marking on the inside of the tank.  
Always unplug the unit immediately after use and before emptying.

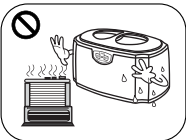

Do not operate the unit next to heat sources such as radiators.  
Operate on a dry level surface.



To avoid electric shock do not immerse the unit into water or other liquid. The unit should not be exposed to dripping or splashing and no objects filled with liquids should be placed on top of it.



Do not fill the tank with abrasives or corrosive chemicals.  
Repeated cleaning cycles will enhance the cleaning effect.



The unit should never be left unattended when plugged in.

## SUGGESTED APPLICATIONS

WHAT CAN, AND WHAT CAN'T I CLEAN?



### Jewellery

Necklaces, Rings, Bracelets etc.



*Porous stones such as pearls etc should not be immersed. Use the optional watch stand to hold the stones out of the water. If in doubt please refer to our website [www.jpl.uk.com](http://www.jpl.uk.com) for more information.*



### Watches and Glasses / Sunglasses

Waterproof wristwatches, Watch chains, Glasses, Sunglasses etc.



*Watches should be fully waterproof (30m or more). For watches that are not waterproof, the optional Watch Stand can be used.*



*To avoid risk of damage, glasses and sunglasses should always be placed 'face up' in the cleaner, ensuring no other objects can touch or rub the lens.*



### Toiletry Items

Electric toothbrush heads, Electric shaver heads, Razor blades, Combs, Toothbrushes, Dentures etc.

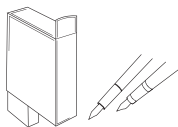

### Office Equipment

Printer heads, Fountain pen nibs, wax or rubber stamps etc.



### Metal Items

Metal cutlery (knives/forks etc), Old coins, Metal badges, Valves, Machine nozzles, Small metal parts etc.



*Any unfirm or inlaid item may become loose. Items that are easy to be discoloured are not recommended for ultrasonic cleaning. eg: Textiles, Leather products, woodware etc.*

*DO NOT put a watch or mobile phone which is NOT waterproof into the tank as damage may occur.*

*DO NOT put any spectacle frame or artware which is made from shell or hawksbill into the tank for cleaning as damage may occur.*

For more applications please refer to our website  
[www.jpl.uk.com](http://www.jpl.uk.com)

# FEATURES AND ACCESSORIES

## **ULTRA 2000** ULTRASONIC CLEANER

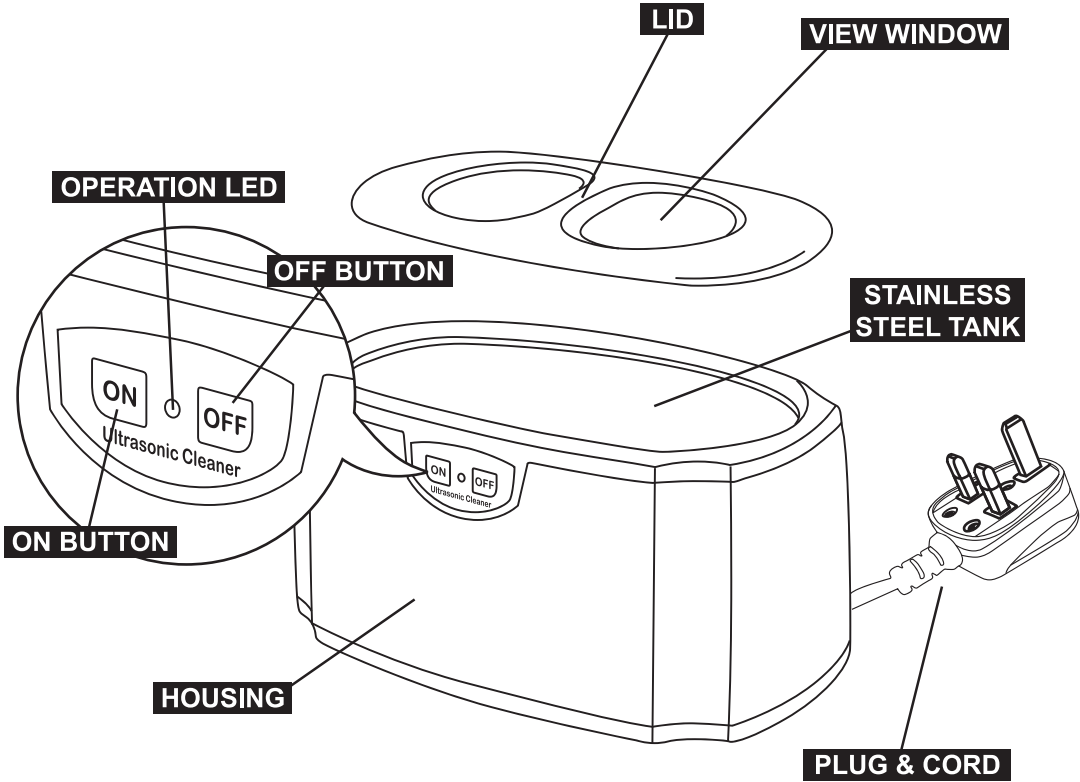

---

### ACCESSORIES

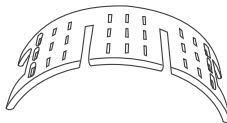

**OPTIONAL  
WATCH STAND / EARRING HOLDER**

# OPERATING INSTRUCTIONS

HOW DO I USE THE ULTRA 2000 CLEANER



**NEVER OPERATE THE UNIT WITHOUT WATER IN THE CLEANING TANK  
- DAMAGE MAY OCCUR  
NEVER USE BOILING WATER - DAMAGE MAY OCCUR**

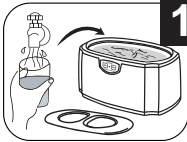

**1**

Open the lid, and fill the stainless steel tank with warm water. (water should not be hotter than 40 - 50 degrees centigrade). Do not exceed the "MAX" marking on the inside of the tank.

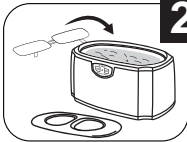

**2**

Place the item to be cleaned into the water. Ensure any items with a delicate surface such as glasses/sunglasses lenses are not touching or rubbing the tank walls or base. Ensure the item is immersed as fully as possible, ensuring the water level does not exceed the "MAX" marking.

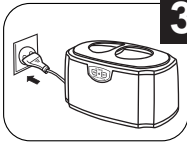

**3**

Close the lid. Ensure your hands are dry, and plug the unit in.

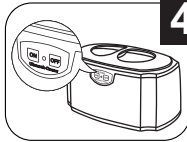

**4**

Press the ON button to start cleaning. The red Operation LED will illuminate while unit is in operation. The built in timer will automatically turn the cleaner off after 3 minutes. Note : During operation the unit will 'Buzz', this is normal.

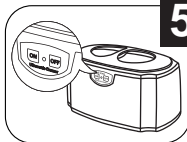

**5**

If required you can stop the cleaning process by pressing the OFF button, or when cleaning has finished you can repeat the process by pressing the ON button again.

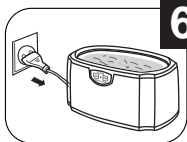

**6**

When cleaning is finished, unplug the unit from the mains, and open the lid to remove the item. Pour away the water and wipe the stainless steel tank with a clean dry cloth.

# DIFFERENT WAYS OF CLEANING

HOW DO I USE THE ULTRA 2000 CLEANER



*NEVER OPERATE THE UNIT WITHOUT WATER IN THE CLEANING TANK  
- DAMAGE MAY OCCUR  
NEVER USE BOILING WATER - DAMAGE MAY OCCUR*

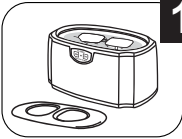

**1**

## GENERAL CLEANING

Use only plain warm water. Ensure the "MAX" marking is not exceeded when immersing the item.

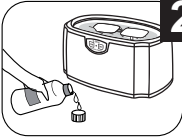

**2**

## ENHANCED CLEANING

If the item is very dirty, or has oil or grease smears (CDs etc), then add a drop or two of standard washing up liquid into the water to enhance the cleaning result. Other non-acidic based cleaning agents can also be used, however it is advised to check with James Products limited first.



**3**

## EXTENSIVE CLEANING

If the item to be cleaned needs extensive cleaning or sterilising, then use the "Enhanced Cleaning" procedure first, then replace with clean water and add a drop or two of liquid soap (eg: hand wash soap) into the tank and repeat the cleaning procedure.



**4**

## CLEANING LARGE ITEMS

If the item is too large to fit completely in the tank, then you can use the ultrasonic cleaner with the item to be cleaned part immersed, with the lid open. Ensure the "MAX" marking is not exceeded when immersing the item.



## REMOVING TARNISH, CARBON & RUST

HOW CAN I CLEAN NON-PLATED (SOLID) METALS



**NEVER OPERATE THE UNIT WITHOUT WATER IN THE CLEANING TANK  
- DAMAGE MAY OCCUR  
NEVER USE BOILING WATER - DAMAGE MAY OCCUR**

When removing tarnish, carbon & rust from your non-plated (eg: solid silver) metals, it is recommended to use a specialist cleaning solution when using your ultrasonic cleaner, as ultrasonic cleaning alone may not achieve the results.

If in any doubt about your items to be cleaned, before use, contact your Jeweller or James Products Ltd for information and advice on cleaning your items.

Sea Clean is designed for use with an ultrasonic cleaner, and will assist in the removal of Tarnish, Carbon, Rust & Dirt from most non-plated metals, to return items to a shiny condition.

The cleaning process should take only a matter of minutes and remove the need for soaking.



Made from a unique formula containing natural products, mixing carefully balanced quantities of SEAWEED, COCONUT OILS and other FRUIT extracts to create a powerful cleaning solution. Sea Clean is non-toxic, non-flammable and bio-degradable using renewable resources.

Sea Clean is available at many stockists.

For more information on Sea Clean and find out where you can purchase, contact James Products Ltd or visit our website [www.jpl.uk.com](http://www.jpl.uk.com)

## USING THE OPTIONAL ACCESSORIES

WHAT ARE THEY FOR AND WHY DO I NEED THEM?



*NEVER OPERATE THE UNIT WITHOUT WATER IN THE CLEANING TANK  
- DAMAGE MAY OCCUR  
NEVER USE BOILING WATER - DAMAGE MAY OCCUR*

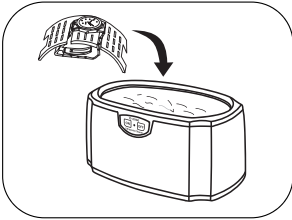

### **WATCH STAND / EARRING HOLDER (OPTIONAL)**

Watches should only be used in ultrasonic cleaners that are waterproof (30m or more). If your watch is not suitable to be fully immersed, then the watch stand can be used to only immerse the strap of the watch, and keep the watch body clear of the water.

Earrings and other jewellery items which should not be immersed for ultrasonic cleaning can be held in place on the holder allowing only the metal parts to be immersed in the water.

As the watch stand / earring holder absorbs about 30% of the ultrasonic energy, it is recommended to use the 'Enhanced Cleaning' method mentioned earlier in this user guide.

# MAINTENANCE AND STORAGE

KEEPING MY CLEANER IN PERFECT CONDITION



**1**

After use, ensure unit is unplugged.  
Pour the water away, and wipe the stainless steel tank and housing with a clean dry cloth.  
To avoid electric shock **DO NOT** wash the unit with water.

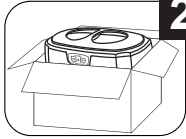

**2**

The unit should be stored in a cool dry place, away from any heat sources (radiators etc) and sources of moisture (bathrooms etc).  
Ideally, the unit should be stored in its original packing for maximum safety.

---

## SPECIFICATION

---

Model Name :	ULTRA 2000
Timer Settings :	3 minutes with automatic shut-off
Tank Size :	450ml stainless steel
Ultrasonic Frequency :	45,000Hz (45 kHz)

---

Power Consumption :	30W Max
Power Supply :	AC 220-240V 50Hz

---

Dimensions (wxhxd) :	198 x 124 x 110mm MAX
Weight (NET) :	0.63kg (1.4lbs)

---

Mains Fuse :	3A
(UK plug only)	When replacing the fuse only a 3A ASTA approved to BS1362 type should be used and be sure to re-fit the fuse cover.

## GUARANTEE

Your ultrasonic cleaner has been carefully manufactured and 100% tested using high quality assured components. It is guaranteed against faulty workmanship and materials for a period of 12 months from the date of purchase. In the unlikely event that a failure should occur, the unit will be repaired or replaced\* free of charge when returned postage paid to the address below within the guarantee period. This guarantee DOES NOT include damage or failure resulting from misuse, damage in transit or failure by the user to comply with the Do's and Don'ts (this list is not exhaustive).

Your statutory rights under common law are in no way affected by this guarantee.

For service in or out of the guarantee period please return the unit postage paid to:

James Products Ltd  
Units 1-3 Moorside House  
Moorside  
Sturminster Newton  
Dorset  
DT10 1HH

Tel: +44 (0)1258 820100

Fax: +44 (0)1258 820550

When returning your unit please ensure that the package contains a covering letter stating when and where you purchased the unit and a description of the problem encountered. If the unit is within the guarantee period please enclose proof of purchase.

\* Repair or replacement is at the discretion of the manufacturer.

In accordance with its policy of progressive product design, James Products Ltd reserves the right to change product specifications without prior notice.

### James Products Limited

Unit 1-3 Moorside House, Moorside,  
Sturminster Newton, Dorset DT10 1HH UK  
Tel : 01258 820100 Fax : 01258 820550

[www.jpl.uk.com](http://www.jpl.uk.com)

### LIMITED WARRANTY

Consequential and incidental damages, including without limitation, loss of property and those arising from breach of any express or implied warranty, are not the responsibility of James Products Limited and to the extent permitted by law, are excluded.

Registered in England no. 5250754  
Registered Office. Ambassador House, 8 Carlton Crescent, Southampton SO15 2EY