

## Wrapmaster 1000 - Instructions for use

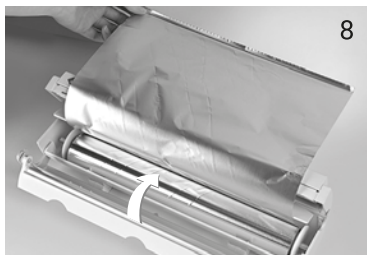
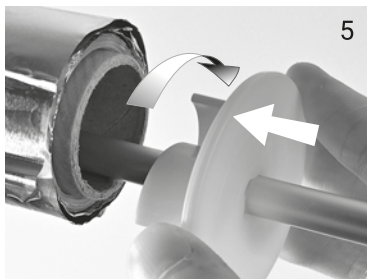

### HOW TO LOAD

1. Unlock at front to open lid, push lever to the left.
2. To open the body, with your index fingers press firmly inwards and upwards on the arrows at each end with thumbs on top for support.
3. Attach the stabilizers (rubber feet) to the base, instructions inside with stabilizers.
4. Push one yellow roll insert onto the bar.
5. Place cling or foil refill on to the bar and twist clockwise onto insert.
6. Push second yellow roll insert onto other end of bar and twist clockwise into the refill.
7. Place loaded bar into the dispenser.
8. Pull out about 8" (20cm) of material (unwinding from the back of the roll), lay this over the top of the lid.
9. Close, making sure both ends lock securely.

Your dispenser is now ready to use.

### HOW TO USE

WM1000 is designed so that it may be held in one hand, or wall mounted.

- To ensure film is "tangle free" use close to the item to be wrapped, **not** while attached to the wall.
- Pull out desired length of material and simply squeeze or press lid closed to cut.
- Allow lid to spring open again to release material. The end is ready for next use.

### HANDY TIPS

- Store in a clean area away from cooking steam. Lock closed, they look neat on a counter. Model 1000 will fit most drawers.
- Holes in the base allow for storing on the wall, if required.
- Keep the feet clean to prevent slipping.
- When cleaning the clamping surfaces use a soft cloth and warm water. Beware of the concealed sharp blade.