

## HOW TO USE THE AERATOR DISPENSER

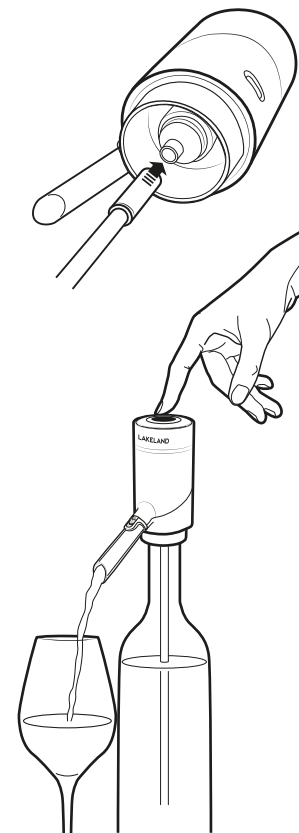

- Remove the cap at the bottom of the dispenser.
- Attach the extension tube onto the dispenser and extend to your desired length.
- Secure the aerating dispenser onto the top of the bottle with the extension tube inside.
- To aerate the wine, move the aeration switch on the valve to the On position. If you want to dispense the wine without aerating, move the aeration switch to Off position.
- Place a wine glass under the dispenser spout, press and hold the power button and the wine will flow smoothly through the aerator channel into the glass. Release the button to stop pouring.

### Hints and Tips

- This product is suitable for most wine bottles where the neck of the bottle has an outer diameter of no more than 35mm and an inner diameter between 17.5mm and 19.5mm.
- When the amount of wine left in the bottle is less than 50ml, it is recommended to switch off the aerator valve when dispensing wine, as the wine may spray a little due to air pressure change.

## FREQUENTLY ASKED QUESTIONS

- Question:** Why is there no wine pouring out of spout when pressing the power button?
- Answer:** Please check the dispenser is inserted firmly into the neck of the bottle and the extension tube is attached correctly. Make sure the end of the extension tube is in the wine.
- Question:** Why is the aerating dispenser pouring slowly and the indicator light is darker than normal?
- Answer:** This could be due to low battery power. Please fully charge the product before using it again.

## CARE AND CLEANING

- Do not immerse the aerating dispenser into water or liquid.
- To clean, fill a clean wine bottle with clean water and dispense the water through the aerating dispenser. Repeat 3 times to thoroughly clean.
- Remove the extension tube and wash in hot, soapy water.
- Clean the aerating dispenser after each use.
- When not in use, store in a clean and dry place.

## TECHNICAL INFORMATION

Input DC: 5V – 0.2A – 1000mAh  
Output DC: 5V – 0.2A – 1000mAh  
Power: 10W

**This product contains a Lithium Battery.**

## RECYCLING YOUR ELECTRICALS

Along with many other high street retailers, Lakeland has joined a scheme whereby customers can take their unwanted electrical products to recycling points set up around the country. Visit [www.recycle-more.co.uk](http://www.recycle-more.co.uk) to find your nearest recycling point.



# LAKELAND

## INSTRUCTION BOOKLET

# RECHARGEABLE WINE AERATING DISPENSER



Model: 63306

**Lakeland**  
Alexandra Buildings, Windermere,  
Cumbria, UK LA23 1BQ  
Tel: +44(0)15394 88100 [lakeland.co.uk](http://lakeland.co.uk)

RECHARGEABLE WINE AERATING DISPENSER

Thank you for choosing the Lakeland Rechargeable Wine Aerating Dispenser.

Please take a little time to read this booklet before getting started and keep it in a safe place for future reference.

The Rechargeable Wine Aerating Dispenser instantly aerates and dispenses wine at a touch of a button.

Here at Lakeland, our award-winning family-owned business still offers the same excellent quality, value for money and exceptional customer service as when we founded the company back in the 1960s.

Our products are hand-picked and thoroughly tested so you can be sure that everything you purchase will be a pleasure to use for many years to come.

PRODUCT FEATURES

- 1. Power button
- 2. Indicator light
- 3. Aerator valve
- 4. Aeration On/Off switch
- 5. Dispenser spout
- 6. Micro USB charging cable
- 7. Charging socket
- 8. Extension tube
- 9. Bottom cap

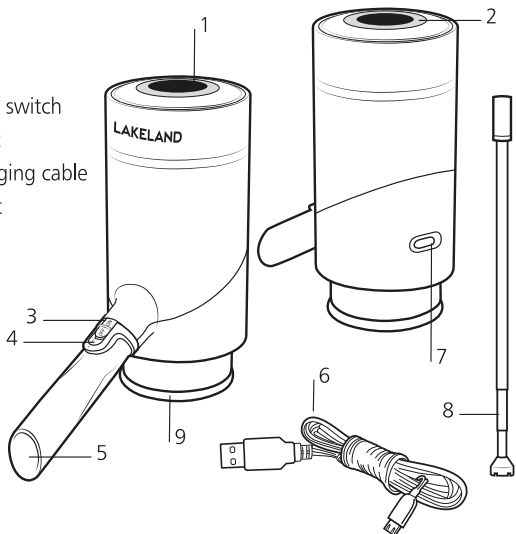

SAFETY CAUTIONS

Carefully read all the instructions before using the appliance and keep in a safe place for future reference. Always follow these safety cautions when using the appliance to avoid personal injury or damage to the appliance. This appliance should be used only as described in this instruction book.

- This appliance can be used by children aged from 8 years and above and persons with reduced physical, sensory or mental capabilities or lack of experience and knowledge if they have been given supervision or instruction concerning use of the appliance in a safe way and understand the hazards involved. Children shall not play with the appliance. Cleaning and user maintenance shall not be done by children unless they are older than 8 and supervised.
- Make sure your electricity supply matches the voltage shown on the appliance.
- Ensure all packaging materials and any promotional labels or stickers are removed from the appliance before the first use.
- Always inspect the appliance before use for noticeable signs of damage. Do not use if damaged or has been dropped. In the event of damage, or if the appliance develops a fault contact the Lakeland customer care team on 015394 88100.
- Do not use this appliance if the lead is damaged. Contact the Lakeland customer care team on 015394 88100.
- Always use the appliance on a dry, level, heat resistant surface, away from any other heat sources.
- Unplug from the mains when not in use and before cleaning. To disconnect, turn the socket to "off" and remove the plug from the mains socket.
- Do not use any accessories or attachments with this appliance other than those recommended by Lakeland.

- To protect against fire, electric shock or personal injury, do not immerse cord, or base in other liquids.
- Do not leave the lead hanging over the edge of a kitchen table or worktop. Avoid contact between the lead and hot surfaces.
- For indoor use only.
- For domestic use only.
- This appliance should be used for preparation of drink as described within the instructions for use that accompany it.
- Always ensure that your hands are dry before removing the plug from the mains socket. Never pull the plug out of the mains socket by its lead.
- To avoid injury or possible fire, do not cover the appliance when in use.
- Do not connect this appliance to an external timer or remote control system.
- An extension cable may be used with care. The electrical rating of the cable should be at least as great as the appliance. Do not allow the cable to hang over the edge of the worktop or touch any hot surfaces.
- This appliance complies with the basic requirements of Directives 2014/30/EU (Electromagnetic Compatibility) and 2014/35/EU (Low Voltage Directive).
- **WARNING:** A cut off plug inserted into a 13 amp socket is a serious safety (shock) hazard. Ensure the cut off plug is disposed of safely.
-  **CAUTION:** The plastic bags used to wrap this appliance or the packaging may be dangerous. To avoid risk of suffocation, keep these bags out of reach of babies and children. These bags are not toys.
- When the power cord is damaged, do not touch the AC power cord with your hands to avoid danger.
- Do not force the aerator onto a bottle, as this could cause damage to the product and the bottle.

BEFORE USING FOR THE FIRST TIME

- Unpack the wine aerator, remove all of the packaging materials.
- Before first use, wipe the outside of the wine aerator with a clean, damp cloth and dry thoroughly.
- Hand wash the extension tube, in warm soapy water, rinse and dry thoroughly. Then run 3 bottles of clean water through the wine aerator before first use.

CHARGING THE WINE AERATOR

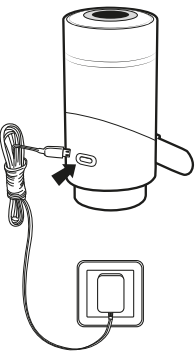

- Insert the micro USB plug to the charging hole of the wine aerator.
- Recharge using the micro USB cable provided via a suitable USB power adaptor or USB recharging point - 100V -240Vac - 50/60Hz.
- Plug the charger into an electrical socket to start the charging.

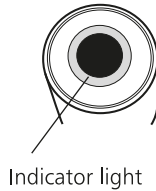

- The indicator light flashes in red when it is charging and stays on when it is fully charged.
- It takes 2.5 hours to fully charge the battery.
- **WARNING:** The indicator light flashes red when the battery power is low. Charge the Wine Aerator before use.