



Distributed by: / Distribué par: / Distribuido por:

Thane Direct Canada Inc.  
Mississauga ON L4W 5M6, Canada  
[www.thane.ca](http://www.thane.ca)

Thane USA, Inc.  
PO BOX 35526, Canton OH 44735, U.S.A.  
[www.thane.com](http://www.thane.com)

Thane Direct UK Ltd  
Thanet House 231-232 Strand,  
London WC2R 1DA  
[www.thane.tv](http://www.thane.tv)

Operadora Ainoa, SAPI de CV  
Av. Magnocentro No. 5 Piso 1  
Col. Centro Urbano Interlomas  
Huixquilucan de Degollado  
Estado de México C.P. 52760  
[www.mejorcompratv.com](http://www.mejorcompratv.com)

Danoz Direct Pty Ltd.  
Bondi Junction, NSW, 2022, Australia  
[www.danoz.com.au](http://www.danoz.com.au)

TVNS Scandinavia AB  
SE-211 74 Malmö, Sweden  
[www.tvins.com](http://www.tvins.com)

"Thane", "H2O HD" and related logos and variations are trademarks or registered trademarks, in Canada and/or other countries, of Thane IP Limited and/or its affiliated companies. "H2O" and related logos and variations are trademarks or registered trademarks, in Canada and/or other countries, of Thane IP Limited and/or its affiliated companies.

© 2020 Thane IP Limited.  
MADE IN CHINA

†Over 13 million "H2O" series steam cleaners have been sold in over 80 countries

H2O HD ENG UK KB RO 201002



# H2O HD™

High Definition  
Steam Cleaner



13  
Million  
SOLD WORLDWIDE\*

## USER'S GUIDE

MODEL No: KB-019/KB-019-1

# Thank You!

Congratulations on your choice of the H2O™ HD High Definition Steam Cleaner from Thane™; a compact yet versatile steam cleaner that easily converts from a Floor Mop and Carpet Cleaner into a powerful Hand-Held Steam Cleaner.

The H2O™ HD Steam Cleaner offers a new definition in steam cleaning, allowing for precise, digital control of the Steam Power offering a High Definition clean that is effective and far more hygienic than conventional methods.

The H2O™ HD Steam Cleaner increases cleaning power by converting water to steam and uses a Microfiber Cloth to enhance absorbency. Dirt and grime can be eliminated in seconds. Cleaning with the H2O™ HD Steam Cleaner is also environmentally friendly, as it uses active steam power without the use of chemicals or detergents. Regular steam cleaning can also help deal with dust mites and some types of bacteria, fungus and mildew.

We want you to get the most from your product, so we'd like to encourage you to read this User's Guide. It will tell you everything you need to know about your H2O™ HD Steam Cleaner including its Digital Steam Control, Quick Release Hand-Held unit and the easy to use Detachable Water Tank, while giving you tips for fast, effective steam cleaning that will leave your home with a High Definition clean.

Thanks again for trusting the H2O™ brand from Thane™!

Thane™ and its affiliated companies assume no liability for personal injury or property damage resulting from the misuse of the H2O™ HD Steam Cleaner, including the failure to comply with the instructions contained in this User's Guide or provided by the manufacturer or distributor of the treated surface.

**IMPORTANT SAFETY INFORMATION**  
**READ ALL INSTRUCTIONS BEFORE USING THIS STEAM CLEANER**

# Cleaning and Maintenance

**⚠ WARNING** DISCONNECT THE UNIT FROM THE POWER OUTLET FOR CLEANING AND MAINTENANCE. DO NOT IMMERSE THE H2O™ HD STEAM CLEANER IN WATER.

## Cleaning procedure to remove lime scale

If your H2O™ HD Steam Cleaner begins to produce steam slower than usual or stops producing steam you may need to remove lime scale. It is necessary to remove lime scale on a regular basis, every 25 times you use a full tank of water or once a month, especially in areas with hard water.

To remove lime scale from the H2O™ HD Steam Cleaner, please follow these procedures:

### Using the Cleaning Pin

Swirl and push the pin up and down the small hole of the steam outlet in the Main Body. Ensure that all scale debris has been removed from the steam outlet before reassembling.

### Using a cleaning solution

1. Prepare a solution of 1/3 white vinegar and 2/3 water and add to the Water Tank.
2. Ensure that steam released is aimed away from the floor or surrounding objects. Plug the unit into a properly grounded electrical outlet, turn it ON and allow the unit to produce steam until the vinegar/water solution is used up.
3. Repeat the above procedure as many times as necessary until a normal steam flow is achieved.
4. Fill the Water Tank with fresh water and rinse out.
5. Fill the Water Tank with fresh water again, and release steam through the system until the Water Tank is empty.
6. Perform a test cleaning on a suitable isolated area after each lime scale removal to ensure that there is no debris left in the system.

Use detergent to clean the accessories when they are dirty. Wash with clean water and air dry.

### To clean calcium deposits building up inside the Water Tank:

Add 1-2 tablespoons of white vinegar to a full Water Tank, close the Water Tank Cap and shake the contents. DO NOT TURN THE STEAMER ON. Let the unit sit for a few hours. Empty the Water Tank and rinse with clean water until it rinses clear.

### Cleaning blocked steamer accessories:

Due to the high mineral content of water in some areas, some calcium buildup might develop inside the tip of the Jet Nozzle. To clean it, we recommend using a spray lubricant. Spray a small burst or two of the lubricant inside the tip of the Jet Nozzle. After spraying the lubricant, fill the steamer with water and run a continuous jet of steam through the affected accessory for several minutes to remove the deposit.

WE RECOMMEND PERFORMING THIS PROCEDURE IN A PROTECTED AND WELL-VENTILATED AREA.

### Microfiber Cloth care:

Machine wash at 60 °C (140 °F) / Do not bleach / Do not use fabric softener.

# Troubleshooting Guide

Problem	Possible Cause	Solution
The unit does not power on	The unit is not plugged in or turned ON	Make sure the unit is plugged into a properly grounded outlet and the switch is ON
Reduced steam or no steam	Water Tank is empty	Fill Water Tank
	Blocked Steam Nozzle	Remove Mop Head and clean the Nozzle
	Lime scale deposit	Follow cleaning procedure to remove lime scale
Steam escapes from connections	Attachment is improperly connected	Turn the unit OFF, allow it to cool down, detach the accessories and reattach them properly
	Debris or obstructions at the connection points	Remove the accessory and check and clean connection points
The cleaning cloth becomes wet	The cloth gets saturated with water after extensive use	Replace with a new cleaning cloth (optional item) or allow cloth to cool, wring out and reattach

For more help visit [www.thanehelp.co.uk](http://www.thanehelp.co.uk)

# Contents

IMPORTANT SAFEGUARDS .....	3
KEY FEATURES .....	4
OPTIONAL ACCESSORIES .....	5
HOW TO ASSEMBLE YOUR H2O™ HD .....	6
HOW TO USE YOUR H2O™ HD .....	7-8
HOW TO ASSEMBLE THE HAND-HELD STEAMER .....	9
HOW TO USE THE HAND-HELD STEAMER .....	9
OPTIONAL ACCESSORY USAGE .....	10-11
AFTER USE AND FILTER .....	12
CLEANING AND MAINTENANCE .....	13
TROUBLESHOOTING GUIDE .....	13

# Important Safeguards

**PLEASE READ ALL PRODUCT INSTRUCTIONS CAREFULLY. FAILURE TO FOLLOW THE PRODUCT INSTRUCTIONS WILL VOID YOUR WARRANTY.**

**USE YOUR H2O™ HD STEAM CLEANER ONLY AS DIRECTED IN THIS MANUAL AND ONLY WITH THE MANUFACTURER'S RECOMMENDED ACCESSORIES. USE OF ATTACHMENTS OR ACCESSORIES NOT PROVIDED OR SOLD BY THE MANUFACTURER OR BY AUTHORIZED RESELLERS MAY CAUSE FIRE, ELECTRIC SHOCK OR INJURY.**

**AS WITH ANY ELECTRICAL APPLIANCE, BASIC PRECAUTIONS SHOULD ALWAYS BE OBSERVED WHEN USING THIS PRODUCT, INCLUDING THE FOLLOWING:**

## **⚠ WARNING**

1. Verify that the main voltage indicated on the Rating Plate on this appliance corresponds with the voltage of your electrical outlet.
2. In order to protect against risk of electric shock, only plug this appliance into properly grounded outlets.
3. This appliance is designed for household use only. Do not use outdoors. Commercial use of the H2O™ HD Steam Cleaner voids the manufacturer's warranty.
4. Do not leave the H2O™ HD Steam Cleaner unattended while plugged in.
5. Close attention is necessary when used near children, pets or plants. Never direct steam towards people, animals or plants, as hot steam emission may cause scalding.
6. Do not allow the H2O™ HD Steam Cleaner to be used as a toy. Children should be supervised to ensure that they do not play with this appliance.
7. This appliance is not intended for use by persons with physical, sensory or mental impairments unless they are instructed and supervised during use by an able and experienced adult responsible for their safety.
8. Do not handle the plug or the H2O™ HD Steam Cleaner with wet hands or operate without shoes. Do not immerse the H2O™ HD Steam Cleaner in water or other liquids. The liquid or steam should not be directed towards equipment containing electrical components, such as the interior of ovens.
9. Do not use this appliance with a damaged cord or plug. If it is not working as it should, or if it has been dropped, damaged, left outdoors, or immersed in water, return it to the distributor. If the supply cord is damaged, it must be replaced by the manufacturer or a qualified repair facility to avoid hazard.
10. Never force the plug into an outlet or pull or carry the unit by the cord. Do not use the cord as a handle, close a door on the cord or pull the cord around sharp edges or corners. Keep the cord away from heated surfaces.
11. Do not use extension cords or outlets with inadequate current-carrying capacity, and in order to avoid circuit overload, do not operate another appliance on the same socket (circuit) as the H2O™ HD Steam Cleaner.
12. To disconnect the H2O™ HD Steam Cleaner press the Power Switch (I / O) to the "OFF" position; then remove the plug from the outlet.
13. Unplug the unit after each use or before servicing. In order to safely unplug the unit, grasp the plug and gently pull. Do not unplug the unit by pulling on the cord.
14. Do not insert any objects into openings in the unit or use it with any of its openings blocked.
15. Store your H2O™ HD Steam Cleaner indoors in a cool and dry place. Never leave the H2O™ HD Steam Cleaner outdoors.
16. Keep your work area well lit and use extra caution when using on stairs.
17. Do not use the unit without water in the Water Tank, and do not use the Mop Head without first attaching the Floor Cloth.
18. Stop using the H2O™ HD Steam Cleaner if you observe water leakage, and contact a qualified technician.
19. Never put hot water or liquids such as alcohol-based or detergent products into the Water Tank. This will make operation unsafe and damage the unit.
20. Always keep the steam opening clear of any obstructions. Avoid placing the steam opening on soft surfaces to avoid blocking the flow of steam. Keep the steam opening free from lint, hair and other potential obstructions to ensure proper steam flow.
21. Do not use the H2O™ HD Steam Cleaner in spaces that are exposed to flammable, explosive or toxic vapor such as paint thinner or oil-based paint.
22. Do not use on leather, wax-polished furniture or floors, unsealed hardwood or parquet floors, unglazed ceramic floors, synthetic fabrics, velvet or other delicate steam-sensitive materials.
23. Do not use this appliance for space heating purposes or place it on or near hot surfaces such as a hot gas or electric burner, or in a heated oven.
24. Do not use this appliance for other than its intended use.

**SAVE THESE INSTRUCTIONS**

# After Use

1. Press the Power Switch to OFF (O).
2. Unplug Power Supply Cord from the electrical outlet.
3. Make sure to remove the Mop Pad/Cloth before storage. Allow it to cool down before carefully removing the cloth.
4. Always empty the Water Tank at the end of each use.
5. Drain left-over water or steam before storing.
6. Wrap Power Supply Cord around Upper and Lower Cord Wrap.
7. Wipe all surfaces of the H2O™ HD Steam Cleaner with a soft cloth.
8. Store in a protected and dry area.



# Filter

It is important to replace the water filter every three to four months or after approximately 20 to 25 uses as the filter becomes visibly dirty. The Water Filter removes minerals and other impurities from tap water and also works to prevent water deposits from damaging your H2O™ HD Steam Cleaner. To maximize the performance of your filter, distilled water may be used.

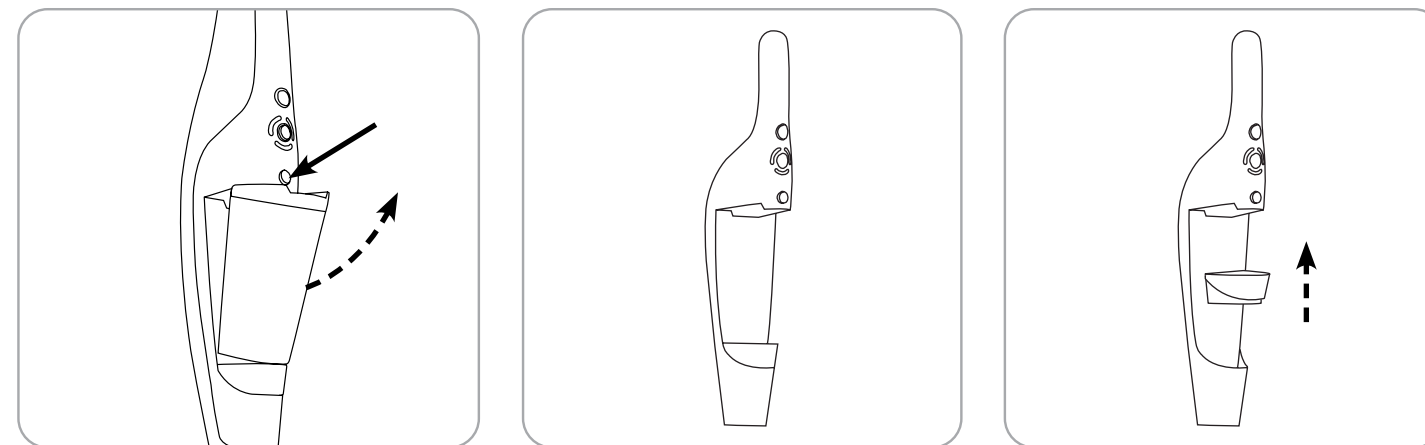
To replace the Water Filter, remove the Water Tank by pressing the Water Tank Release Button and pulling the Water Tank from both sides. With the Water Tank removed, grab and lift the Water Filter from the Handheld Steamer and discard. Replace with a new Water Filter from Thane™. Replace Water Tank and follow instructions for "How to use your H2O™ HD Steam Cleaner."

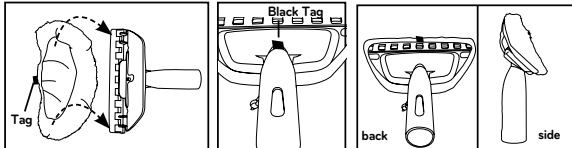
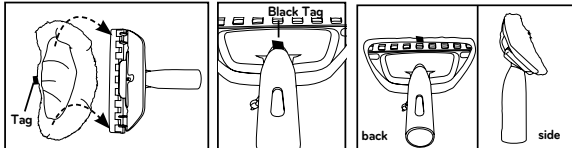
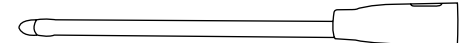
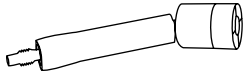

# Optional Accessory Usage

Part and Usage	Assembly	Tips/Caution
<p><b>GARMENT STEAMING CLOTH</b> To steam a garment, place item of clothing on a hanger and steam the garment directly. Slowly slide the Garment Steamer Head vertically over the garment to smooth the fabric and remove wrinkles and odors.</p>	<p>Install the Garment Steaming Cloth / Lint Cloth / Microfiber Scrubbing Cloth over the Window Cleaning Tool. Make sure to attach the cloth to all hooks on the Cleaning Tool Frame to avoid slipping from the frame during use.</p> 	<p>For garment steaming do not use High Steam setting.</p> <p>Some fabrics like leather, suede, and velvet may not be suitable for steaming. Please refer to the manufacturer's label.</p> <p>Curtains and draperies can be steamed while hanging.</p>
<p><b>LINT CLOTH</b> Slowly pass over surface to be cleaned. The absorbent Lint Cloth picks up the dirt/hair loosened by the steam.</p>		<p>Do not use High Steam setting. Do not use on animals.</p>
<p><b>MICROFIBER SCRUBBING CLOTH</b> Removes more dust and dirt with less effort. Effective in cleaning stubborn smudges or spills.</p>		
<p><b>LONG STEAM LAZER™</b> Easier to clean hard to reach areas (behind the cabinets, behind the toilet, far corners, etc.).</p>	<p>Attach the Long Steam Lazer™ to the Extension Hose by aligning the lock button on the Extension Hose with the designated hole on the Long Steam Lazer™ tool and push until it locks in place. Attached to the Extension Hose, the Long Steam Lazer™ can be used by itself or with the Bendable Jet Nozzle and/or Round Brush (Nylon). Remove the end cap before installing the Bendable Jet Nozzle or Round Brush (Nylon).</p> 	
<p><b>BENDABLE JET NOZZLE</b> Cleans tight corners and hidden places.</p>	<p>Screw the Bendable Jet Nozzle onto the Long Steam Lazer™. Remove the black plastic cap from the top of the Long Steam Lazer™. Replace the plastic cap after attaching the Bendable Jet Nozzle.</p> 	
<p><b>ACCESSORY BAG</b> Keeps all accessories and small parts in one place. Easy to view the contents and easily locate the needed tool or accessory and access it.</p>		<p>Handle with care as tools and accessories with sharp ends might poke through the bag (Scraper, Nozzle, etc.)</p>

# Key Features

1. Foldable Handle
2. Cord Lock Slot
3. Foldable Handle Release Button
4. Upper Cord Wrap
5. Hand-Held Steamer Release Button
6. Hand-Held Unit
7. Power Switch with Power Indicator Light
8. Steam Power Button
9. Steam Power Level Indicator
10. Water Tank Release Button
11. Water Tank Light
12. Water Tank
13. Water Filter
14. Power Supply Cord
15. Lower Cord Wrap
16. Mop Head Screw
17. Mop Head
18. Microfiber Cloth
19. Carpet Glider

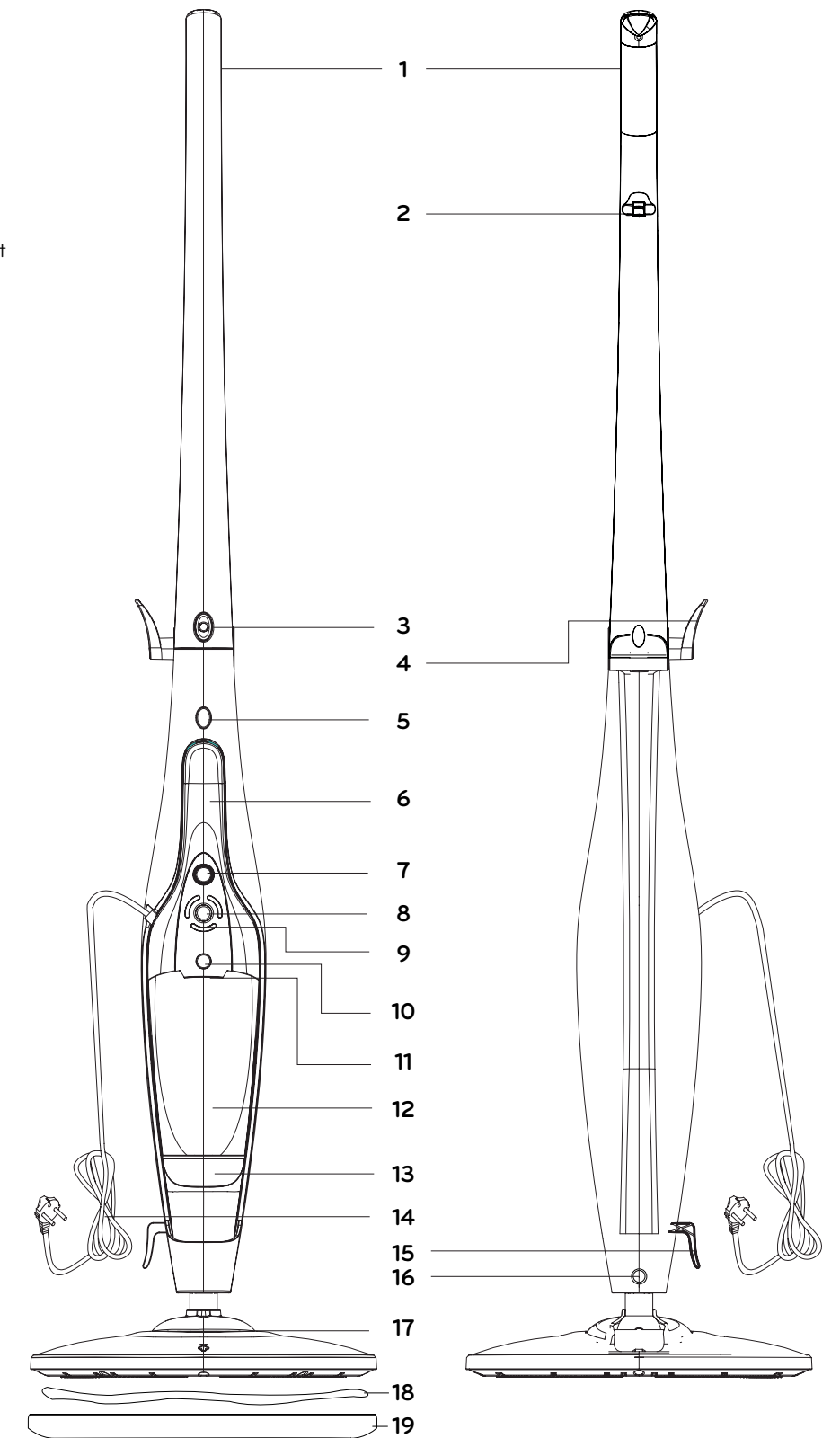

Front view

Back view

# Optional Accessories

## Included with your H2O HD

1. Jet Nozzle
2. Round Brush (Nylon)
3. Copper Brush
4. Cleaning Pin
5. Extension Hose (for the Hand-Held Steamer)
6. Window Cleaning Tool
7. Window Cleaning Cloth
8. Garment Steaming Cloth
9. Duster with Coral Cloth

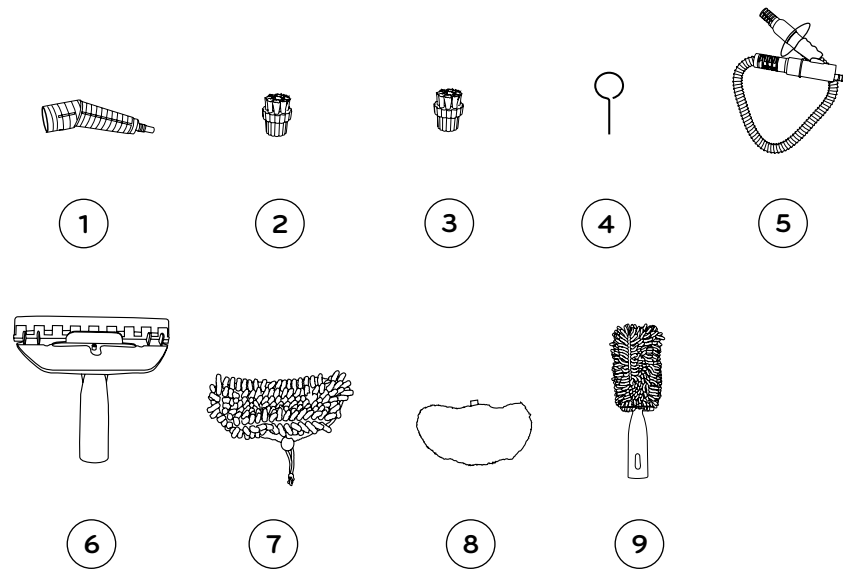

## Available for purchase separately at [www.thane.tv](http://www.thane.tv)

10. Lint Cloth
11. Microfiber Scrubbing Cloth for Window Cleaning Tool
12. Long Steam Lazer™
13. Bendable Jet Nozzle
14. Additional Round Brushes in different colors
15. Accessory Bag
16. Microfiber Scrubbing Cloth for Mop Head
17. Coral Cloth for Mop Head
18. descaler
19. scent

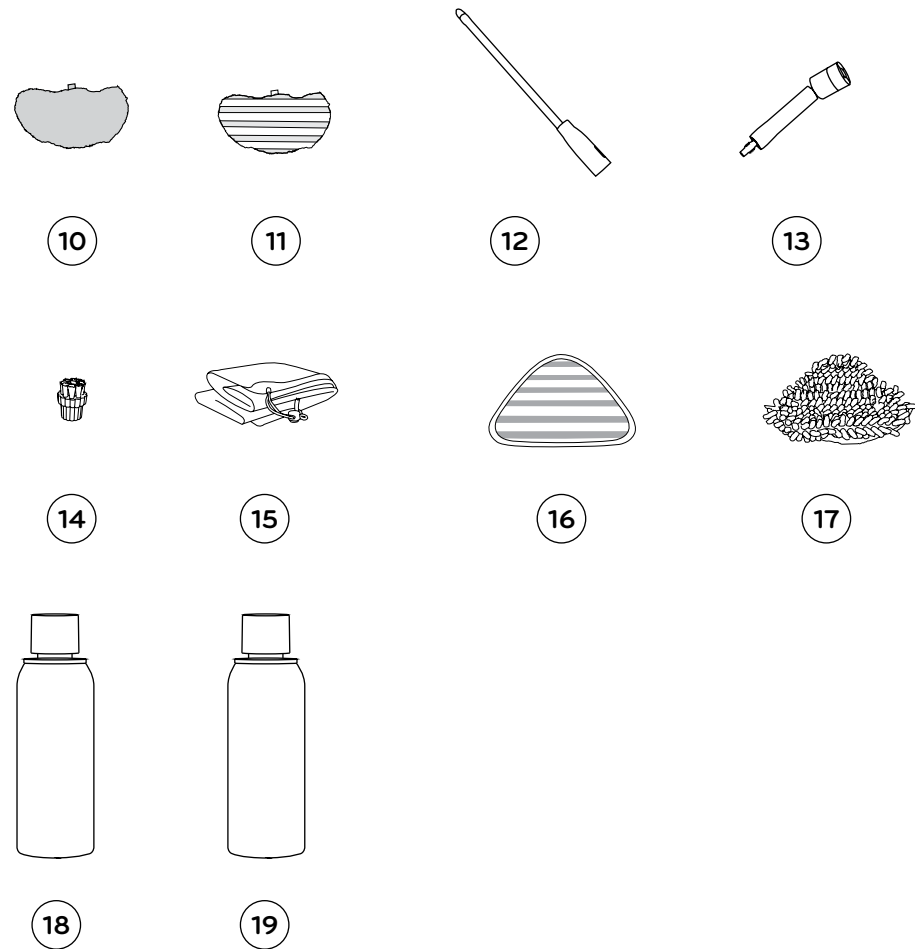

# Optional Accessory Usage

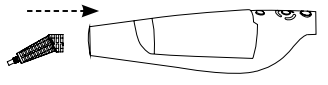
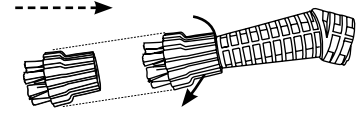
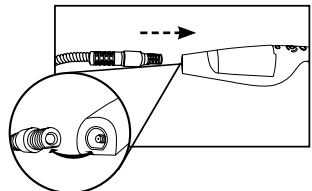
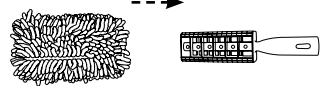
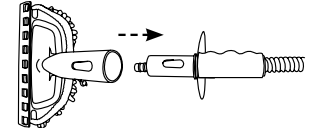
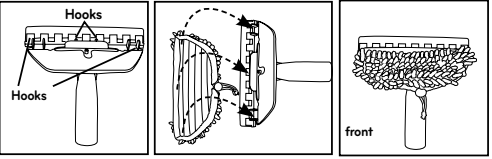
Part and Usage	Assembly	Tips/Caution
<b>JET NOZZLE</b> Produces powerful steam for cleaning corners and gaps.	Insert the Jet Nozzle into the designated hole in the Main Body until it safely locks in place. 	Make sure the Jet Nozzle is securely locked in place before usage.
<b>NYLON BRUSH</b> The round nylon brush is great for cleaning smooth, hard surfaces, such as toilets, sinks, and kitchen counters, etc. It can be used with soap or detergent to clean dirty areas.	Nylon Brush or Copper Brush can be attached to any of the steam nozzles.  Attach either of the brushes by screwing onto the threaded end of the Jet Nozzle, Bendable Jet Nozzle or Long Steam Lazer. 	Use different colored brushes for cleaning different areas of your home (kitchen, bathroom, etc.).  Never use the Copper Brush on surfaces that are prone to scratching.
<b>COPPER BRUSH</b> The Copper Brush is great for cleaning coarse or metal surfaces, such as brick floors, car wheels, metal doors, and metal frames, etc.		
<b>EXTENSION HOSE</b> This 30" Extension Hose is designed for use with the Hand-Held Steamer and with the following attachments: - Window Cleaning Tool - Duster - Bendable Jet Nozzle - Long Steam Lazer™	Insert the designated end of the Extension Hose into the designated hole in the Main Unit until it locks in place. 	Make sure the Extension Hose is securely locked into place before usage. When in use, keep the Extension Hose away from your body and avoid touching the hose as it can get hot.  Do not pull the Extension Hose with excessive force, as it might cause damage and result in a steam leak.
<b>DUSTER, WITH CORAL CLOTH</b> Slowly pass over surface to be cleaned. The absorbent Coral Cloth picks up the dirt loosened by the steam.	Install the Coral Cloth into the Duster Frame and attach the Duster to the Extension Hose. 	Do not use High Steam setting when using the Duster.
<b>WINDOW CLEANING TOOL</b> Attached to the Extension Hose and in combination with one of the provided cleaning cloths or scraper, use this tool for window cleaning, garment steaming, wallpaper removal, etc.	Align the lock button on the Extension Hose with the designated hole on the Window Cleaning Tool Frame and push in the Extension Hose until it locks in place. Install cleaning cloth of your choice onto the Window Cleaning Tool. 	Do not use steam on frozen windows.  Be careful when using the steamer on glass, as the glass may break.
<b>WINDOW CLEANING CORAL CLOTH</b> Use it to clean windows, mirrors and glass.	Install the Coral Cloth over the Window Cleaning Tool. Do not cover the squeegee blade or scraper when installing the cleaning cloth. 	Do not use steam on frozen windows.  Be careful when using the steamer on glass, as the glass may break.

# How to Assemble the Hand-Held Steamer

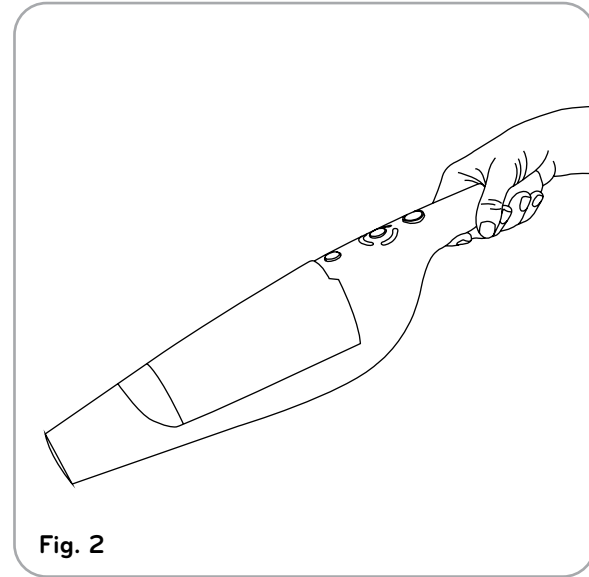
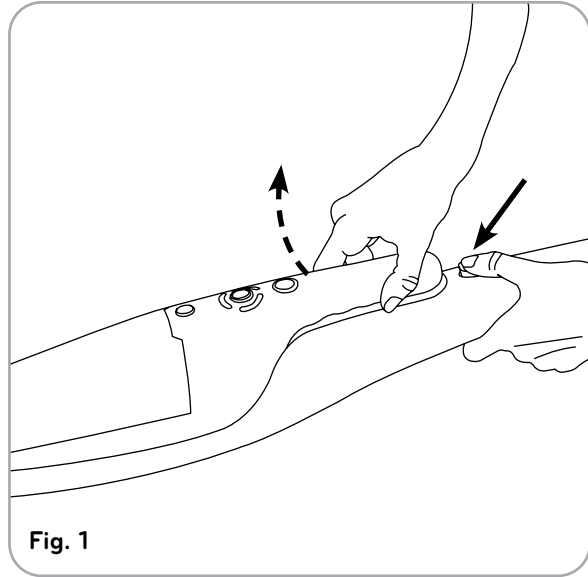

The Hand-Held Steamer is an ideal portable cleaner for use on work surfaces, countertops, sinks, windows, mirrors, tiles and spot cleaning on floors, carpets and rugs. Remove the Power Supply Cord from the Cord Lock Slot and detach from the Main Body by pressing the Hand-Held Steamer Release Button and remove by the handle. Use your Hand-Held Steamer to clean windows, glass and mirrors without leaving annoying streaks and smears. With available accessories like the Duster attachment you can clean blinds, handrails and furniture. The Garment Steamer attachment relaxes the fabric, so wrinkles simply disappear. It also helps remove stains and body odors.

The Hand-Held Steamer is designed to thoroughly clean and help sanitize many of the surfaces in your home without harsh chemicals. Whether it's the bathroom or kitchen, nursery or backyard grill – now you can GREEN CLEAN with digital steam settings that make the H2O™ HD Steam Cleaner great for virtually any cleaning job.

## To detach the Hand-Held Steamer:

Step 1: Remove the Power Supply Cord from the Cord Lock Slot.

Step 2: Detach the Hand-Held Steamer by pressing the Hand-Held Release Button and pulling out the Hand-Held Steamer unit (Fig. 1).

**CAUTION** Make sure the H2O™ HD Steam Cleaner is unplugged before assembly.

# How to Use the Hand-Held Steamer

Fill the Water Tank with water (refer to the "HOW TO USE YOUR H2O™ HD" section in this manual) and select and attach one of the available attachments (please refer to the "ACCESSORY USAGE" section in this manual).

## Select one of the Steam Regulator positions:

### 1. Low Steam – Blue Indicator Light

Ideal for sensitive surfaces such as Garments, Mattresses & Pillows, Upholstery, Sealed Hardwood/Laminate (may also use Medium Steam setting)

### 2. Medium Steam – Green Indicator Light

Ideal for light cleaning of Plastic, Granite & Marble, Tile, Slate and Windows & Mirrors

### 3. High Steam – Red Indicator Light

Ideal for tougher stains on Stainless Steel, Porcelain Fixtures and Carpets & Door Mats

## NOTICE

- Do not use the Hand-Held Steamer to clean frozen windows.
- Be careful when using the Hand-Held Steamer on glass, as the glass may break.

# How to Assemble Your H2O™ HD

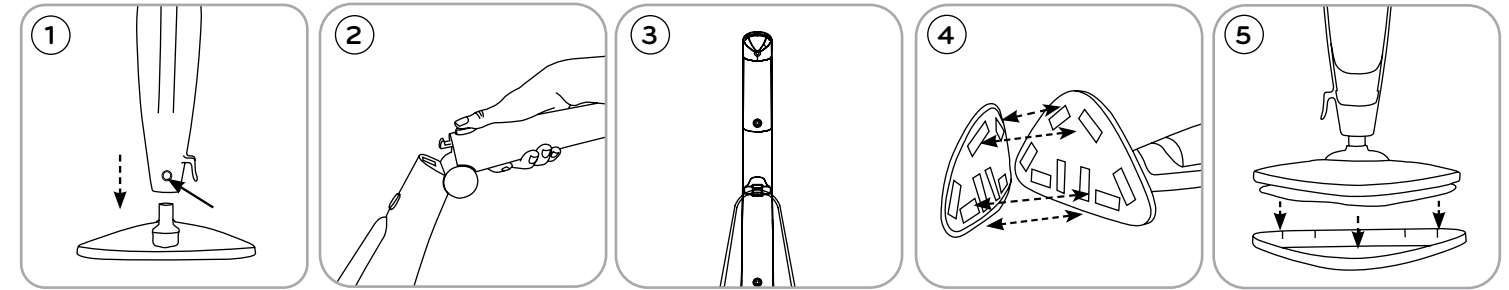

**Step 1:** Attach the H2O™ HD Mop Head, then insert and tighten the provided screw into the hole on the back (screwdriver not provided).

**Step 2:** Pull handle upwards to an upright and locked position.

**Step 3:** Insert the Power Supply Cord into the Cord Lock Slot located on the handle.

**Step 4:** Attach the Microfiber Cloth by placing the cloth under the Mop Head. Align fastening strips of the cloth with the gripping strips on the bottom of the Mop Head. Press to fit together.

**Step 5:** When using the H2O™ HD Steam Cleaner on carpeting or rugs: Place the Mop Head, with Microfiber Cloth in place, on top of the Carpet Glider as illustrated in Fig. 5. Do not attempt to use the H2O™ HD Steam Cleaner on carpeting or rugs without the Carpet Glider in place. Never use the Carpet Glider on surfaces that are prone to scratching.

**CAUTION** Make sure that the unit is unplugged from an electrical outlet and the Power Switch ( I / O ) is in the "OFF" ( O ) position before assembling the unit or changing the accessories.

# How to use your H2O™ HD

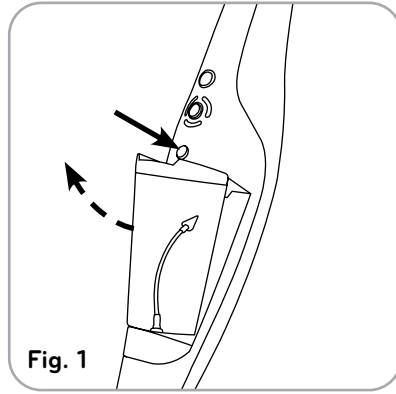

Fig. 1

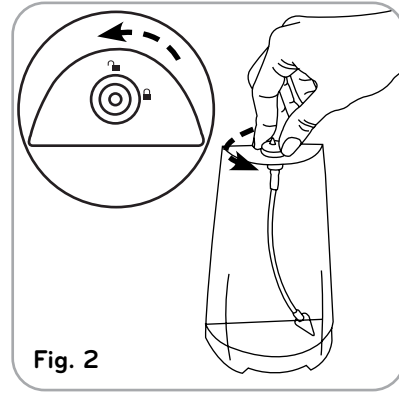

Fig. 2

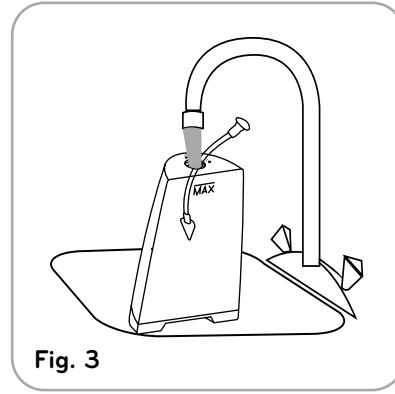

Fig. 3

## To fill the Water Tank:

Ensure the H2O™ HD Steam Cleaner is unplugged. Remove the Water Tank by pressing the Water Tank Release Button and pulling the Water Tank from both sides (Fig. 1). Turn the Water Tank Cap from the bottom of the Water Tank to "OPEN" and remove the Water Tank Cap (Fig. 2). Fill the Water Tank to the indicated tank capacity (450ml/15.2oz) (Fig. 3). Replace the Water Tank Cap and turn to "CLOSE" position. Make sure the Copper Cone inside the Water Tank is always submerged in water while operating the unit.

Never put cleaning detergents into the Water Tank. Unless approved by the manufacturer, do not put any scented products in the Water Tank. The H2O™ HD Steam Cleaner uses tap water, but in areas with hard water use distilled water for better performance.

Once the unit has been fully assembled and filled with water, plug the Power Cord into an electrical outlet.

## Turning the unit ON:

1. Press Power Switch (I / O) to "ON" (I) position; a Red Power Indicator light will come on, indicating power is on. At the same time the Blue Water Tank Light will come on.
2. Wait for approximately 15 to 25 seconds for the Steam Power Level Indicator lights to flash, indicating that the unit is ready to use.
3. Press the Steam Power Button to your desired power level; for Low Steam, press the button once, two times for Medium Steam and three times for High Steam. Pressing the button again will bring you back to the Low Steam setting.
4. To stop emitting steam, press the Power Switch to "OFF" (O) position and unplug the Power Supply Cord from the electrical outlet.

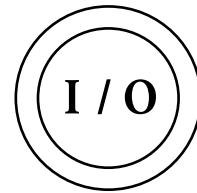

**Tip:** The H2O™ HD Steam Cleaner will return to its previous setting if the Power Switch is pressed to the "ON" (I) within 5 seconds of being turned "OFF" (O).

## Select one of the Steam Power Level positions:

### 2. Medium Steam – Green Indicator Light

Ideal for light cleaning of Plastic, Granite & Marble, Tile, Slate and Windows & Mirrors



### 3. High Steam – Red Indicator Light

Ideal for tougher stains on Stainless Steel, Porcelain Fixtures and Carpets & Door Mats

### 1. Low Steam – Blue Indicator Light

Ideal for sensitive surfaces such as Sealed Hardwood/Laminate (may also use Medium Steam setting), Garments, Mattresses & Pillows, and Upholstery

# How to use your H2O™ HD

The H2O™ HD Steam Cleaner is designed to thoroughly clean floor surfaces, such as marble, ceramic, carpet, stone, linoleum, sealed hardwood floors and parquet. Test the H2O™ HD Steam Cleaner on a small isolated area of your floor prior to overall use on floor surfaces. The heat and steam action may remove the wax on surfaces treated with wax. Do not let unit stand on any wood or heat-sensitive floors for an extended period of time. Water marks, discoloration or damage to the floor surface can occur if the unit is left operating too long in one place. When using on vinyl, linoleum or any other heat-sensitive floors, use extra caution. Too much heat can melt glue in the flooring. Use only on laminate flooring that has been laid professionally and without gaps or cracks that would permit the entry of moisture. Not all floor types are suitable for steam cleaning. Always check the use and care instructions of your flooring manufacturer or distributor before using the H2O™ HD Steam Cleaner. When in doubt consult a flooring specialist.

## Start Cleaning:

Slowly pass over the surface to be cleaned. The absorbent mop cloth picks up the dirt loosened by the steam. Apply steam as needed. When the H2O™ HD Steam Cleaner stops producing steam, simply turn it off, unplug it from the electrical outlet and refill the Water Tank to continue cleaning.

**WARNING** Never leave the H2O™ HD Steam Cleaner unattended while plugged in.

For Best Results:

1. Sweep or vacuum floor prior to using the H2O™ HD Steam Cleaner.
2. To avoid puddling of water, the Microfiber Cloth must be clean and dry for use. To replace the cloth, proceed as follows: Let the cloth cool down, remove cloth from unit, replace with a new Microfiber Cloth (optional item) and continue use. Select Low Steam power level.
3. To help sanitize an area of your floor, leave the H2O™ HD Steam Cleaner at a High Steam power level over the area for about 10 seconds, but no longer than 15 seconds.

**WARNING** Do not carry out this procedure on heat and steam sensitive floors.

**IMPORTANT**

- Never steam on one spot for too long. This can cause floor surface damage.
- Do not put hands or feet under the steam mop. Unit gets very hot.
- During use a pulsing noise may be heard indicating that the mop is producing steam. This noise is normal.
- There may be some minor "spitting" of water mixed with the steam. This is also normal.
- The force and heat of the steam may adversely affect certain materials. Always check the suitability of using steam on a surface by carrying out a preliminary test on a hidden area.