



KitchenAid

Sifter+Scale Attachment 5KSMSFTA



EN	Use & Care manual	2	NO	Håndbok for bruk og vedlikehold	115
DE	Gebrauchs- und Pflegeanleitung	15	FI	Käyttö- ja huolto-opas	127
FR	Manuel d'utilisation et d'entretien	29	DA	Vejledning til anvendelse og vedligehold	139
IT	Manuale d'uso e manutenzione	43	IS	Notenda & Meðhöndlunar handbók	151
NL	Gebruiks- en onderhoudshandleiding	55	RU	Руководство по эксплуатации и уходу	163
ES	Manual de uso y cuidado	67	PL	Instrukcja obsługi i konserwacji	175
PT	Manual de utilização e manutenção	79	CS	Návod k použití a údržbě	187
EL	Εγχειρίδιο Χρήσης και Φροντίδας	91	TR	Kullanım ve Bakım kılavuzu	199
SV	Handbok för skötsel och användning	103	AR	دليل الاستخدام والعناية	1





PARTS AND FEATURES

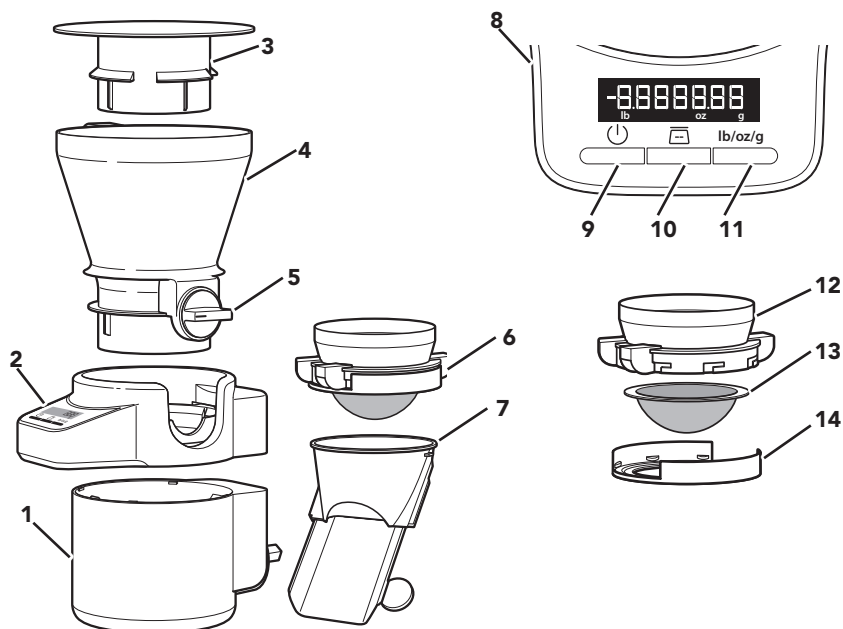

- | | | | |
|----------|------------------------------------|-----------|---|
| 1 | Sifter Housing | 8 | Digital Scale Display and Control Panel |
| 2 | Digital Scale | 9 | On/Off Button |
| 3 | Lid/Scale Plate | 10 | Tare Button |
| 4 | Ingredient Hopper | 11 | Weight Unit Toggle |
| 5 | Ingredient Valve | 12 | Sifter |
| 6 | Sifter Assembly (see detail below) | 13 | Screen |
| 7 | Swivel Chute | 14 | Collar |





PRODUCT SAFETY

Your safety and the safety of others are very important.

We have provided many important safety messages in this manual and on your appliance. Always read and obey all safety messages.



This is the safety alert symbol.

This symbol alerts you to potential hazards that can kill or hurt you and others.

All safety messages will follow the safety alert symbol and either the word “DANGER” or “WARNING.” These words mean:

! DANGER

You can be killed or seriously injured if you don't immediately follow instructions.

! WARNING

You can be killed or seriously injured if you don't follow instructions.

All safety messages will tell you what the potential hazard is, tell you how to reduce the chance of injury, and tell you what can happen if the instructions are not followed.

IMPORTANT SAFEGUARDS

When using electrical appliances, basic safety precautions should always be followed, including the following:

1. Read all instructions. Misuse of appliance may result in personal injury.
2. This appliance is not intended for use by persons (including children) with reduced physical, sensory, or mental capabilities, or lack of experience or knowledge, unless they are closely supervised and instructed concerning use of the appliance by a person responsible for their safety.
3. European Union only: This appliance shall not be used by children. Keep the appliance and its cord out of reach of children.
4. European Union only: Appliances can be used by persons with reduced physical, sensory, or mental capabilities or lack of experience and knowledge if they have been given supervision or instruction concerning use of the appliance in a safe way and understand the hazards involved. Children shall not play with the appliance.
5. Turn the appliance off, unplug from outlet and detach the Sifter+Scale attachment from appliance before cleaning and when not in use. Turn the appliance off and make sure the motor stops completely before putting on or taking off parts.
6. Children should be supervised to ensure that they do not play with the appliance.
7. Never leave the appliance unattended while it is in operation.
8. Avoid contacting moving parts. Keep hands, hair, and clothing, as well as spatulas and other utensils away from accessories during operation to reduce the risk of injury to persons and/or damage to the appliance.
9. To protect against risk of electrical shock, do not put appliance in water or other liquid.



PRODUCT SAFETY

10. The use of attachments not recommended or sold by KitchenAid may cause fire, electric shock, or injury.
11. Do not use the appliance outdoors.
12. Also see the Important Safeguards section included in the Stand Mixer Use and Care Guide.
13. Refer to the “Care and Cleaning” section for instructions on cleaning the surfaces in contact with food.
14. This appliance is intended to be used in household and similar applications such as:
 - staff kitchen areas in shops, offices, or other working environments;
 - farmhouses;
 - by clients in hotels, motels and other residential type environments;
 - bed and breakfast type environments.

SAVE THESE INSTRUCTIONS

Instructions are also available online, visit our website at:
www.KitchenAid.co.uk or www.KitchenAid.eu

ELECTRICAL EQUIPMENT WASTE DISPOSAL

Disposal of packing material

The packing material is recyclable and is marked with the recycle symbol (♻️). The various parts of the packing must therefore be disposed of responsibly and in full compliance with local authority regulations governing waste disposal.

Scrapping the product

- This appliance is marked in compliance with European Directive 2012/19/EU, Waste Electrical and Electronic Equipment (WEEE).
- By ensuring this product is disposed of correctly, you will help prevent potential negative consequences for the environment and human health, which could otherwise be caused by inappropriate waste handling of this product.



- The symbol  on the product or on the accompanying documentation indicates that it should not be treated as domestic waste but must be taken to an appropriate collection centre for the recycling of electrical and electronic equipment.

For more detailed information about treatment, recovery and recycling of this product, please contact your local city office, your household waste disposal service or the shop where you purchased the product.

DECLARATION OF CONFORMITY

This appliance has been designed, constructed and distributed in compliance with the safety requirements of EC Directives: 2014/35/EU, 2014/30/EU, 2009/125/EC and 2011/65/EU (RoHS Directive).





PRODUCT USAGE

SIFTER+SCALE CONFIGURATIONS

The Sifter+Scale attachment is compatible with all household KitchenAid Stand Mixers, including all accessory stainless steel, glass, and ceramic bowls. It is not compatible with the Precise Heat Mixing Bowl, Ice Cream Maker, or the Pouring Shield.

The Sifter+Scale attachment can be used in multiple ways: to weigh and sift ingredients while slowly feeding them into the mixer bowl or into a separate container, to weigh and feed ingredients without sifting, and to weigh ingredients on your countertop.

1

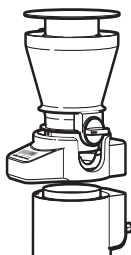

To weigh, sift, and slowly feed ingredients into mixer bowl or separate container: Use the complete attachment for recipes calling for ingredients to be sifted and fed slowly into the mixer bowl or a separate container.

2

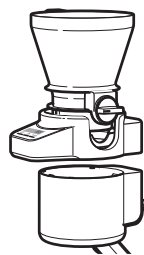

To weigh and feed ingredients into bowl without sifting: Use the attachment without the Sifter when weighing and feeding larger ingredients, such as whole oats, that do not need to be sifted. To add those ingredients slowly, you can limit the flow by using the Ingredient Valve.

3

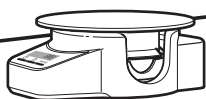

To use as a countertop scale: Set the scale on your countertop or table and place the Lid/Scale Plate on top.



PRODUCT USAGE

ATTACHING THE SIFTER HOUSING TO THE STAND MIXER

Before using your Sifter+Scale for the first time, wipe the Ingredient Hopper, Sifter Assembly, and Swivel Chute with a warm damp cloth, then wipe clean with a damp cloth. Do not wash the Sifter Housing or Digital Scale. Dry with a soft cloth. See the "Care and cleaning" section for complete instructions.

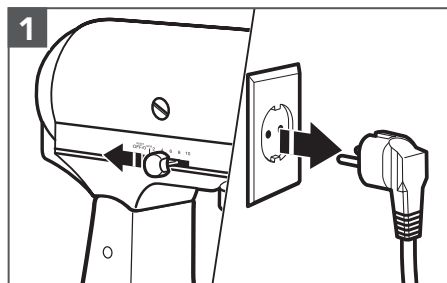

Turn the Stand Mixer OFF(0) and unplug.

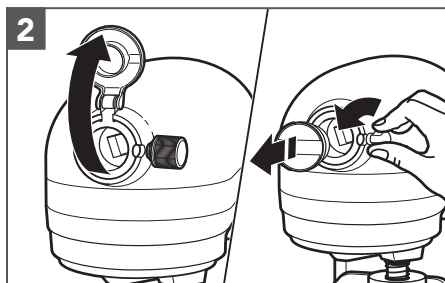

For Stand Mixers with a hinged attachment hub cover: Flip up to open.
For Stand Mixers with a removable attachment hub cover: Turn the attachment knob counterclockwise to remove attachment hub cover.

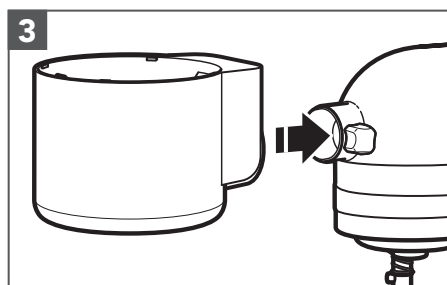

Insert the attachment Shaft Housing into the attachment hub, making certain the power shaft fits into the square hub socket. If necessary, rotate the attachment back and forth. The pin on the attachment housing will fit into the notch of the hub rim when in the proper position.

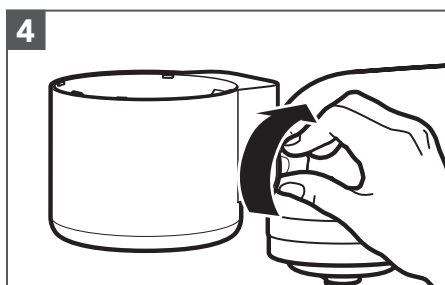

Tighten the Stand Mixer attachment hub knob clockwise until the attachment is completely secured to the Stand Mixer.





PRODUCT USAGE

ASSEMBLING THE SIFTER+SCALE ATTACHMENT

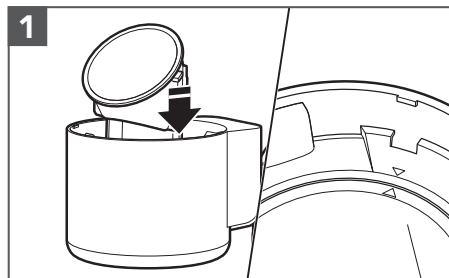

To install the Swivel Chute: Lower the Swivel Chute into the Sifter Housing at an angle, aligning the marks on the Swivel Chute with the marks above the notches on the inside of the Sifter Housing. Properly installed, Swivel Chute will be seated securely in the Sifter Housing and will rotate easily.

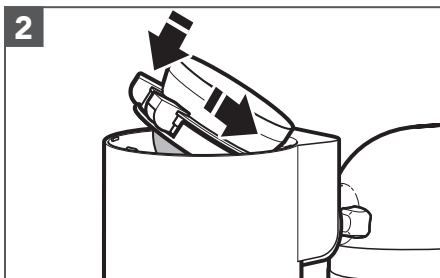

To install the Sifter Assembly: Lower the Sifter into the Sifter housing at an angle so that the drive shaft can be inserted into the Sifter Housing. Once the shaft is inserted all the way, press down on the Sifter, opposite of the shaft, to click it into place.

TIP: Aligning the handle tab on the chute with one of the notches as you lower the Swivel Chute into the Sifter Housing will help you to line up the marks.

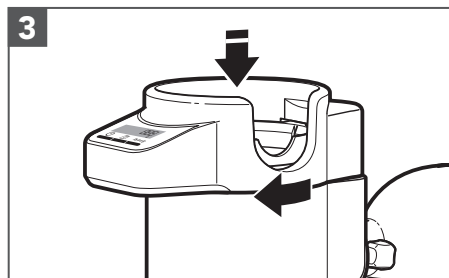

To install the scale: Place the scale on top of the Sifter Housing with the Digital Scale display facing away from the Stand Mixer, and slightly left of centre. Twist the scale counterclockwise until it locks into place.

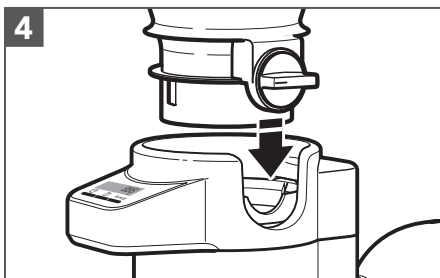

To install the Ingredient Hopper: Align the Ingredient Valve with the corresponding notch on the scale, and lower the hopper onto the scale until fully seated.





PRODUCT USAGE

WEIGHING AND SIFTING INGREDIENTS

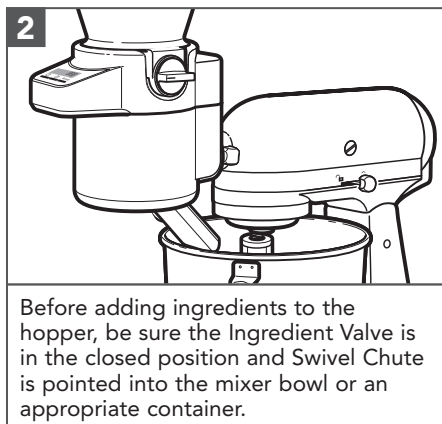
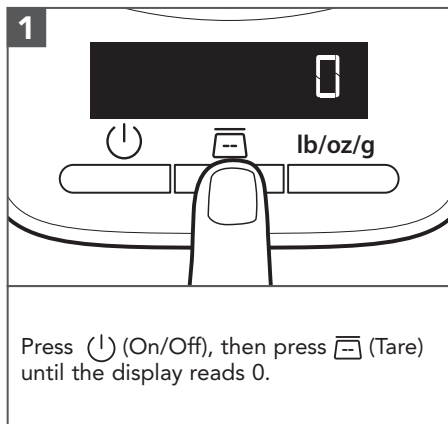

NOTE: If desired, the scale and hopper can sit on the countertop, and ingredients can be added until the target weight is achieved. The full scale and hopper can then be installed onto the attachment.

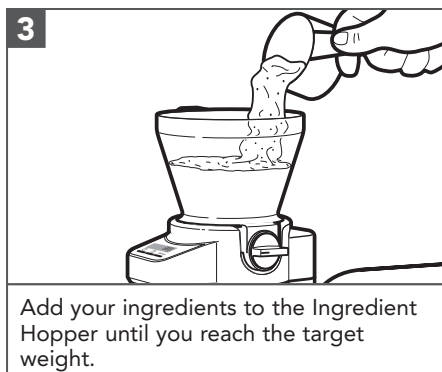
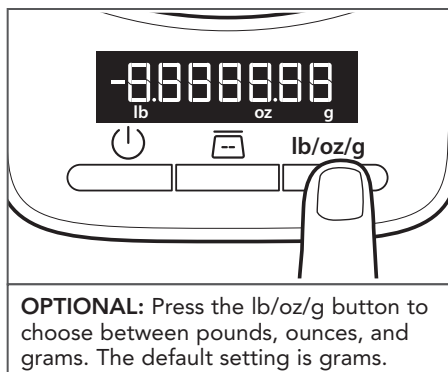

TIP: Make sure your dry ingredients have no large or hard clumps before feeding them through the Sifter. As with any Sifter, large or hard clumps may not be broken up during the sifting process.





PRODUCT USAGE

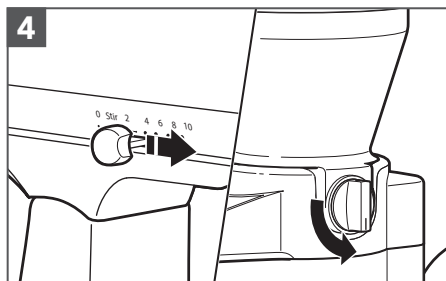

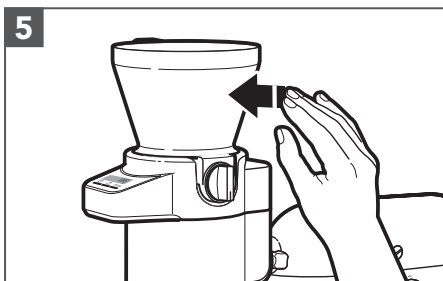

Turn on the Stand Mixer to the desired speed, then open the Ingredient Valve. The ingredients will be sifted and flow into the bowl according to the selected speed.

NOTE: The Sifter can operate at any speed, so select the speed that works best for your recipe.



Once sifting appears to be complete, tap the housing and then the chute to release all residual ingredients.

TIP: If your recipe calls for multiple dry ingredients, press  between adding ingredients for weighing, and stir them in the hopper before opening the Ingredient Valve.

NOTE: Once you've weighed your ingredients, you may turn off the scale at any time by pressing . The scale will also shut off automatically after 5 minutes of non-use.

CARE AND CLEANING

CLEANING THE SIFTER+SCALE ATTACHMENT AND ACCESSORIES

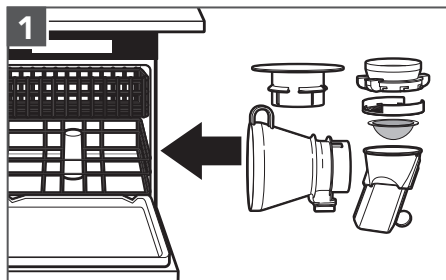

The following parts are dishwasher-safe, top rack only: Ingredient Hopper, Sifter Assembly, Swivel Chute, and Scale Plate.

TIP: When placing the Ingredient Hopper on the rack, be sure it is lying on its side with the Ingredient Valve facing down.

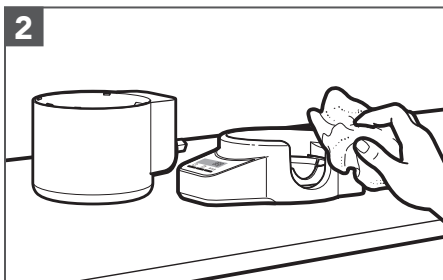

Do not immerse the Scale or Sifter Housing in water or other liquid. Wipe clean with a warm, damp cloth, and dry thoroughly with a soft cloth before re-use or storing.



CARE AND CLEANING

3

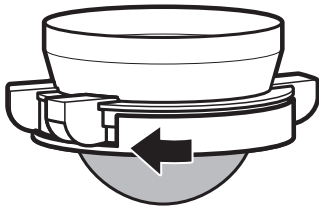

To disassemble the Sifter assembly: Turn the Collar to the left to loosen and release the screen for cleaning, if desired.

REPLACING THE BATTERIES

The digital scale of your Sifter+Scale attachment is powered by 2 AAA batteries (included).

1

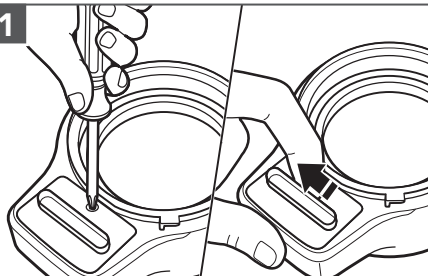

Flip the digital scale over, and use a Phillips-head screwdriver to remove the screw on the compartment cover. Lift the compartment cover as shown.

2

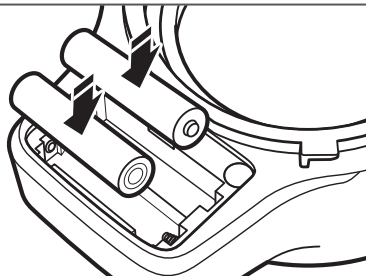

Replace the 2 AAA batteries in the compartment. Make sure to replace the screw when reattaching the compartment cover.

TROUBLESHOOTING GUIDE

Problem	Solution
While using the Sifter+Scale attachment, you may see the following messages displayed:	Err The scale has exceeded its weight limit. Remove ingredients from hopper, and try again with a smaller amount.
	- - - Err1 Tare error. Remove ingredients and turn off power. Then, turn power back on. If Err1 is still present, call customer service.
If the problem cannot be corrected:	See the "Terms of KitchenAid Guarantee ("Guarantee")" section. Do not return the product to the retailer. Retailers do not provide service.





TERMS OF KITCHENAID GUARANTEE ("GUARANTEE")

Covering U.K. - Ireland - South Africa - UAE

KitchenAid Europa, Inc., Nijverheidslaan 3, Box 5, 1853 Strombeek-Bever, Belgium ("Guarantor") grants the end-customer, who is a consumer, a Guarantee pursuant to the following terms.

FOR U.K.:

The Guarantee applies in addition to and does not limit or affect the statutory warranty rights of the end-customer against the seller of the product. In summary, the Consumer Rights Act 2015 says products must be as described, fit for purpose and of satisfactory quality. During the expected lifespan of your product your legal rights entitle you to the following:

- Up to 30 days: if your product is faulty, then you can get an immediate refund.
- Up to six months: if your product can't be repaired or replaced, then you're entitled to a full refund, in most cases.
- Up to six years: if your product does not last a reasonable length of time you may be entitled to some money back.

These rights are subject to certain exceptions. For detailed information please visit the Citizens Advice website www.adviceguide.org.uk or call 03454 04 05 06.

FOR IRELAND:

The Guarantee applies in addition to and does not limit or affect the statutory warranty rights of the end-customer against the seller of the product under the European Communities (Certain Aspects of the Sale of Consumer Goods and Associated Guarantees Regulations 2003 (S.I. No. 11/2003)) and other enactments governing the sale of consumer goods.

FOR SOUTH AFRICA:

The Guarantee applies in addition to and does not limit or affect the statutory warranty rights of the end-customer against the seller of the product. In summary, the Consumer Protection Act, 2008 says that products must be: (i) reasonably suitable for the purpose for which they are intended; (ii) in good working order, of good quality and free of any defects; (iii) useable and durable for a reasonable period of time, having regard to the use to which they would normally be put and to all the surrounding circumstances; and (iv) in compliance with any applicable standards or any other public regulations.

During the expected lifespan of your product and where the products are not purchased online, your legal rights will entitle you to the following:

- You will be entitled to a full refund, if you did not have the opportunity to examine the product before delivery and if you rejected delivery of the product on the basis that the type and quality of the product was not as reasonably expected or did not reasonably conform to the material specifications.
- Within 5 business days after delivery: you may rescind your purchase and request a refund, if your purchase resulted from direct marketing.
- Within 10 business days after delivery: you will be entitled to a full refund, if it is found that the product was unsuitable for a particular purpose specifically communicated to you by the Guarantor.
- Within 15 business days after delivery: you will be entitled to a refund if: (i) the product was not delivered to you; or (ii) if you returned the product to the Guarantor.
- Within 6 months after delivery: you will be entitled to a refund or a replacement product, if the product is defective or fails to operate in terms of its specifications.





TERMS OF KITCHENAID GUARANTEE ("GUARANTEE")

Where you have purchased a product online your legal rights will be governed by the Electronic Communications and Transactions Act, 2002 and you will be entitled to the following:

- Within 7 days after conclusion of the transaction or after delivery: you may cancel your purchase without reason and without penalty.
- Within 30 days of the date of cancellation of the transaction: you will be entitled to receive a refund, if you have already made payment.
- You will only be liable for the direct costs of returning the product to the Guarantor.

FOR UAE:

The Guarantee applies in addition to and does not limit or affect the statutory warranty rights of the end-customer against the seller of the product.

1) SCOPE AND TERMS OF THE GUARANTEE

a) The Guarantor grants the Guarantee for the products mentioned under Section 1.b) which a consumer has purchased from a seller or a company of the KitchenAid-Group within the following countries: U.K., Ireland, or South Africa, or the United Arab Emirates (UAE).

b) The Guarantee period depends on the purchased product and is as follows:

5KSMSFTA Two years full guarantee from date of purchase.

c) The Guarantee period commences on the date of purchase, i.e. the date on which a consumer purchased the product from a dealer or a company of the KitchenAid-Group.

d) The Guarantee covers the defect-free nature of the product.

e) The Guarantor shall provide the consumer with the following services under this Guarantee, at the choice of the Guarantor, if a defect occurs during the Guarantee period:

- Repair of the defective product or product part, or
- Replacement of the defective product or product part. If a product is no longer available, the Guarantor is entitled to exchange the product for a product of equal or higher value.

f) If the consumer wishes to make a claim under the Guarantee, the consumer has to contact the country specific KitchenAid service centres or the Guarantor directly at KitchenAid Europa, Inc. Nijverheidslaan 3, Box 5, 1853 Strombeek-Bever, Belgium;

Email-Address U.K.: CONSUMERCARE.UK@kitchenaid.eu

Email-Address IRELAND: CONSUMERCARE.IE@kitchenaid.eu

Toll Free Number U.K. & IRELAND: **00 800 381 040 26**

FOR SOUTH-AFRICA:

Our local KitchenAid Distributor:

KitchenAid Africa
PO Box 52102
V&A Waterfront
Cape Town
8002





TERMS OF KITCHENAID GUARANTEE ("GUARANTEE")

Contact our distributor:

Telephone: +27 21 555 0700

You can contact our Customer Service Centre for Small Domestic Appliances from 8.30 am to 1.00pm and from 1.30 pm to 5.00 pm or write to us at the following address: hello@kitchenaidafrica.com

FOR UAE:

AL GHANDI ELECTRONICS.

POST BOX NO. 9098,

DUBAI, UNITED ARAB EMIRATES

Toll free number: +971 4 2570007

g) The costs of repair, including spare parts, and any postage costs (if applicable) for the delivery of a defect-free product or product part shall be borne by the Guarantor. The Guarantor shall also bear the postage costs for returning the defective product or product part if the Guarantor or the country specific KitchenAid customer service centre requested the return of the defective product or product part. However, the consumer shall bear the costs of appropriate packaging for the return of the defective product or product part.

h) To be able to make a claim under the Guarantee, the consumer must present the receipt or invoice of the purchase of the product.

2) LIMITATIONS OF THE GUARANTEE

a) **The Guarantee applies only to products used for private purposes and not for professional or commercial purposes.**

b) **The Guarantee does not apply in the case of normal wear and tear, improper or abusive use, failure to follow the instructions for use, use of the product at the wrong electrical voltage, installation and operation in violation of the applicable electrical regulations, and use of force (e.g. blows).**

c) **The Guarantee does not apply if the product has been modified or converted, e.g. conversions from 120 V products to 220-240 V products.**

d) **The provision of Guarantee services does not extend the Guarantee period, nor does it initiate the commencement of a new Guarantee period. The Guarantee period for installed spare parts ends with the Guarantee period for the entire product.**

e) **FOR SOUTH-AFRICA & UAE ONLY:**

Further or other claims, in particular claims for damages, are excluded unless liability is mandatory by law.

After expiry of the Guarantee period or for products for which the Guarantee does not apply, the KitchenAid customer service centres are still available to the end-customer for questions and information.

Further information is also available on our website:

- For U.K. & Ireland www.kitchenaid.eu

- For South-Africa: www.kitchenaidafrica.com

- For UAE: www.KitchenAid-MEA.com

PRODUCT REGISTRATION

Register your new KitchenAid appliance now: <http://www.kitchenaid.eu/register>

©2020 All rights reserved.

KITCHENAID and the design of the Stand Mixer are trademarks in the U.S. and elsewhere.



