

CRUX

2-Slice Toaster Instruction Manual

Styled for Life
Designed & Engineered in New York City

Thank you for Purchasing this Product

You may already be familiar with using a similar product, but do please take the time to read these instructions - they have been written to ensure you get the very best from your purchase.

Safety is Important

To ensure your safety and the safety of others, please ensure you read the Product Safety and Electrical Safety Information before you operate this product. Keep these instructions in a safe place for future reference.

Technical Information

Voltage/Frequency: 220-240V-50/60Hz 770-920W

Table of Contents

Product Safety	2-3
Electrical Safety.....	4-5
Features.....	6
Before Using for the First Time	7
How To Use The Toaster	7
Browning Control.....	7
Bagel Function	8
Gluten free Function.....	8
Reheat Function	8
High Lift Function	9
Cancel Function.....	9
Cleaning and Maintenance.....	9
Storage	10
Servicing	10
Guarantee	11
Disposal Information.....	12

Product Safety

Hot toast can burn. Do not place or operate your Toaster near or below curtains, or any other combustible material.

Do not leave your Toaster unattended when it is being used.

IMPORTANT

- The appliance can be used by children aged from 8 years and above and persons with reduced physical, sensory or mental capabilities, or lack of experience and knowledge, if they have given supervision or instruction concerning the use of the appliance in a safe way and understand the hazards involved. Cleaning and user maintenance shall not be made by children unless they are 8 years or above and supervised.
- Always use this appliance on a stable, level surface, close to a power socket and out of reach of young children.
- Always ensure that hands are dry before handling the plug or switching on the appliance.
- Always carry out regular checks on the appliance and power cord. Should there be any signs of damage, do not attempt to use or repair. This appliance has no user serviceable parts.
- Always ensure that your toaster is not used under a cupboard or close to a wall as this may cause scorching.
- Always ensure that the bread fits easily into the slots, torn or extra thick slices can cause your toaster to jam.
- Always exercise caution when removing any bread lodged in the slots, so as not to damage the internal mechanism or heating elements. Do not insert metal objects when removing bread.
- Always lift your toaster from underneath, do not place your fingers inside or near the bread slots. Clean the crumb tray regularly: Crumbs can smoke or burn.

- Always unplug this unit when not in use and before cleaning.
- Always allow the appliance to fully cool down before cleaning or storing.
- Never immerse the appliance, cord or plug into water or any other liquid. This is to protect against electrical shock.
- Never use this appliance for other than intended use. This appliance is for household use only. Do not use outdoors.
- Never allow young children to use this appliance, close supervision is necessary when this appliance is in use near children. Children shall not play with the appliance
- Never let the power cord hang over the edge of a worktop, touch hot surfaces or become knotted, trapped or pinched.
- Never place on or near heat sources.
- Never leave this appliance unattended during use.
- Never touch the exposed metal parts of the toaster during use as they will become very hot during use.
- Never place bread or other items on top of the toasting slots as this may cause damage to the toaster and create a fire hazard.
- Never operate this toaster near or below combustible materials, such as curtains, as this may be a fire risk.
- Never attempt to remove bread that has lodged in the slots without first unplugging your toaster from the mains supply. Allow to cool completely before attempting to remove toast that has jammed.
- Never use a metal object e.g. knife to remove/release bread that is lodged in the toaster.
- Never operate this toaster by means of an external timer or separate remote control system.

Electrical Safety

Read these instructions thoroughly before using this appliance or connecting it to the mains supply.

A 13 amp BS1362 ASTA approved fuse must be fitted.

This appliance must be earthed.

There are no user-serviceable parts inside this appliance.

Always refer servicing to qualified service personnel.

The mains lead of this product is not replaceable by the user.

If the mains lead is damaged, the entire appliance should be returned to an approved Service Centre for repair.

Do not allow this product to be exposed to rain or moisture during use or storage.

Before switching on, make sure that the voltage of your electricity supply is the same as that indicated on the rating plate. Connecting it to any other power source may cause damage. The mains lead of this product is not replaceable by the user. If the mains lead is damaged, the entire appliance should be returned to the Customer Service Department or replaced by suitably qualified persons in order to avoid a hazard.

If the plug has to be changed because it is not suitable for your socket, or due to damage, it should be cut off and a replacement fitted, following the wiring instructions shown. The old plug must be disposed of safely because inserting it into a 13 amp socket could cause an electrical hazard.

The wires in the power cable of this product are coloured in accordance with the following code:

Blue = Neutral

Brown = Live

Green/Yellow = Earth

If the markings on the terminals of your plug do not correspond to the colours of the wires in the power cable, proceed as follows:

- The wire which is coloured **Blue** must be connected to the terminal which is marked **N** or coloured **Black**.
- The wire which is coloured **Brown** must be connected to the terminal which is marked **L** or coloured **Red**.
- The wire which is coloured **Green/Yellow** must be connected to the terminal which is marked with the earth symbol (\perp) or coloured **Green**.

Plug should be BS1362/ASTA approved.

Fit a 13 Amp fuse.

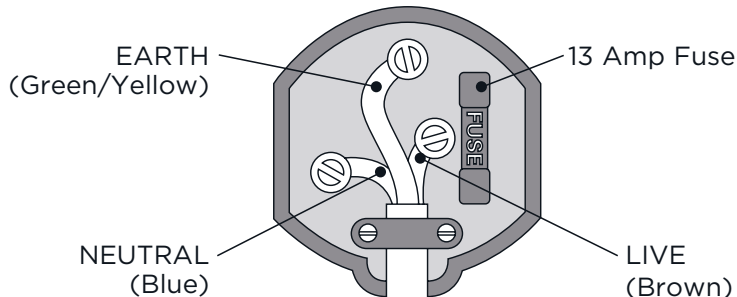

Ensure that the outer sheath of the cable is firmly held by the clamp.

5

Features

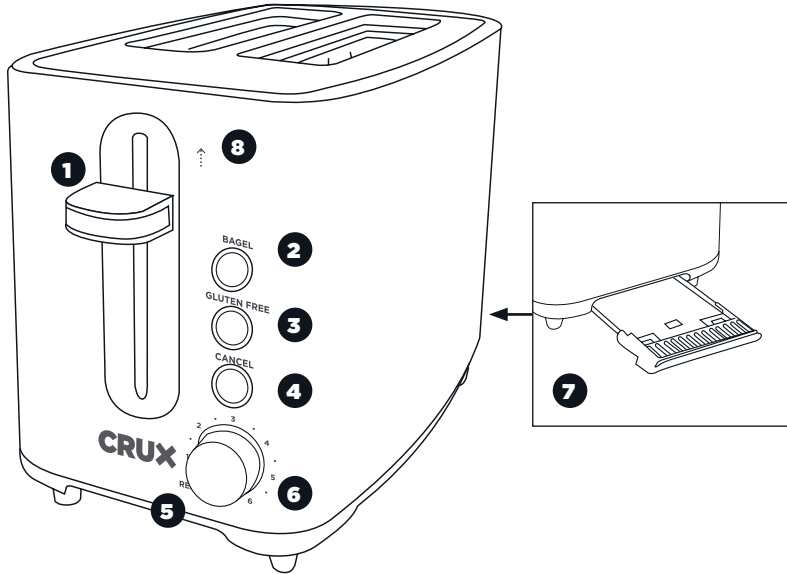

Product may vary slightly from illustration

- | | | |
|-----------------------|---------------------|-------------------------|
| 1. Loading lever | 4. Cancel button | 7. Removable crumb tray |
| 2. Bagel button | 5. Reheat setting | 8. High lift function |
| 3. Gluten Free button | 6. Browning control | |

Technical Information

Voltage/Frequency: 220-240V-50/60Hz

Wattage: 770-920 watts

Before Using for the First Time

Remove all protective packaging and any stickers before using for the first time.

There may be manufacturing residue or oil remaining in the toaster or heating element, which might emit an odour at the time of the first use. This is normal and will not occur after several uses. It is suggested to operate the toaster without bread for first use according to the below steps. Then let the toaster cool down before you start toasting the first slice.

How To Use The Toaster

1. Ensure the toaster is connected to the main power supply.
2. Place one to two slices of bread into the toasting slots and press the loading lever down until it latches. The toaster will heat up automatically and start toasting.
NOTE: the toaster must be connected to the main power supply in order for the bread carriage to engage and for the toasting cycle to begin
3. Adjust the browning control to brown the toast to your desired taste.
4. To stop toasting press the CANCEL button at any time.
5. The loading lever will rise automatically when toasting is finished.
This toaster is equipped with a high lift lever to help with the removal of smaller items.
6. If the toast is not dark enough, you can toast the bread again. Adjust the browning control to your desired setting and replace the toast. Ensure the toast does not burn while re-toasting.

Browning Control

The browning control enables adjustment of toasting time and has the following settings:

- Reheat – for warming pre-toasted bread
- 1-2 for light toasting
- 3-4 for medium toasting
- 5-6 for dark toasting

Bagel Function

The bagel setting works great for English muffins, too!

1. Place one half in each toasting slot with the cut sides facing the centre.
2. Set the browning control to desired setting.
3. Press the loading lever down.
4. Press the BAGEL button. The bagel indicator will light up. Ensure bagel doesn't burn.
5. The loading lever will rise automatically when the toasting cycle is complete.

Gluten Free Function

Use your toaster to toast, reheat or defrost your Gluten-free bread, bagels and waffles. Gluten-free breads are often denser in quality and requires a longer toasting time. The gluten free function adjusts and adds the ideal amount of time to your toasting cycle in order to ensure precise and even toasting.

Note: The gluten free function does not remove the gluten from your bread.

1. Place one bread, bagel or waffle in each toasting slot.
2. Set the browning control to desired setting.
3. Press the loading lever down.
4. Press the GLUTEN FREE button to toast. The Gluten-free button will light up. Ensure toast/ bagel/ waffle doesn't burn.
5. The loading lever will rise automatically when the toasting cycle is complete.

Reheat Function

Your Toaster can reheat bread if it has cooled too quickly.

1. Replace the bread in the toaster.
2. Set the browning dial to the lowest setting. The arrow on the dial should be position to REHEAT.
3. Press the loading lever down.
4. The loading lever will rise automatically when the toasting cycle is complete.

High Lift Function

Allows the loading lever to be raised further for easier access to smaller breads. This ensures smaller pieces of bread and bagels can be removed easily.

Cancel Function

The CANCEL button can be pressed at any time during toasting to interrupt the toasting cycle.

CAUTION:

1. If toaster starts to smoke, press CANCEL to stop toasting immediately.
2. Do not toast food with runny ingredients.
3. Never attempt to remove bread jammed in the slots without first unplugging the toaster from the electrical outlet. Be sure not to damage the internal mechanism or heating elements when removing bread.
4. The bread slot is to be used for toasting regular bread slices only. Do not use the toaster to toast irregularly shaped bread as it may become lodged in the toaster.

Cleaning and Maintenance

1. Disconnect the toaster from the power socket before cleaning.
2. Wipe the outside with a soft dry cloth after toaster cools down. Never use metal polish.
3. Pull out crumb tray on bottom of toaster and empty it. If toaster is used frequently, accumulated bread crumbs should be removed at least once a week. Make sure the crumb tray is inserted correctly to the toaster and completely closed before using the toaster again.
4. The power cord may be wound under the bottom of the toaster when not in use or for storage.
5. This appliance requires little maintenance. Do not try to repair it yourself. Any servicing requiring disassembly must be performed by a qualified appliance repair technician.

Storage

Ensure that the toaster has completely cooled down and is clean before storing away. Store your appliance in its packing box or in a clean dry place.

Servicing

If you drop or damage your toaster it should not be used until it has been examined by an authorised service centre or appliance technician. Always refer servicing to qualified service personnel.

Guarantee

This product is guaranteed for 3 years from the date of original purchase against mechanical and electrical defects.

Please register at <http://mpl.direct/cruxwarranty> within 28 days of purchase.

Any defect that arises due to faulty materials or workmanship will either be replaced or refunded where possible during this period by the dealer from whom you purchased the unit.

The following conditions apply:

- The guarantee does not cover accidental damage, misuse, cabinet parts, knobs or consumable items.
- The product must be correctly installed and operated in accordance with the instructions contained in this manual.
- It must be used only for domestic purposes.
- The guarantee will be rendered invalid if the product is re-sold or has been damaged by inexpert repair.
- Specifications are subject to change without notice.
- The manufacturer disclaims any liability for the incidental or consequential damages.
- The guarantee is in addition to, and does not diminish your statutory or legal rights.
- Valid in the UK only.

Customer Helpline: 0345 467 6743

Disposal Information

Waste electrical products should not be disposed of with household waste. Please recycle where facilities exist. Check with your local authority for recycling advice.



This symbol on appliance, instruction manual and packaging puts your attention to this important issue. The materials used in this appliance can be recycled. By recycling used domestic appliances you contribute an important push to the protection of our environment. Ask your local authorities for information regarding the point of recollection

For technical queries, please contact: MPL Home Ltd,
IMEX, 575 -599 Maxted Road, Hemel Hempstead, Herts, HP2 7DX



For customer service questions or comments
0345 467 6743
cruxkitchen.co.uk
 crux.kitchen

CRUX is a trademark of 8479950 Canada Inc.
All rights reserved.

SO-314285 Rev. 3 (2017-05-04)