

5KGB



KitchenAid

English	5
Deutsch	13
Français	21
Italiano	29
Nederlands	37
Español	45
Português	53
Ελληνικά	61
Svenska	69
Norsk	77
Suomi	85
Dansk	93
Íslenska	101
Русский	109
Polski	117
Český	125
Türkçe	133
العربية	141

TABLE OF CONTENTS

PARTS AND FEATURES	6
Parts and accessories.....	6
GLASS BOWL SAFETY	7
Important safeguards	7
Waste disposal.....	8
USING THE GLASS BOWL	9
Attaching the glass bowl to the Stand Mixer.....	9
Attaching the thread ring to the glass bowl.....	9
Attaching the glass bowl to the Stand Mixer.....	10
Removing the glass bowl from the Stand Mixer	10
Removing the thread ring from the glass bowl.....	11
Tips for use	11
CARE AND CLEANING	11
WARRANTY AND SERVICE	12

PARTS AND FEATURES

PARTS AND ACCESSORIES

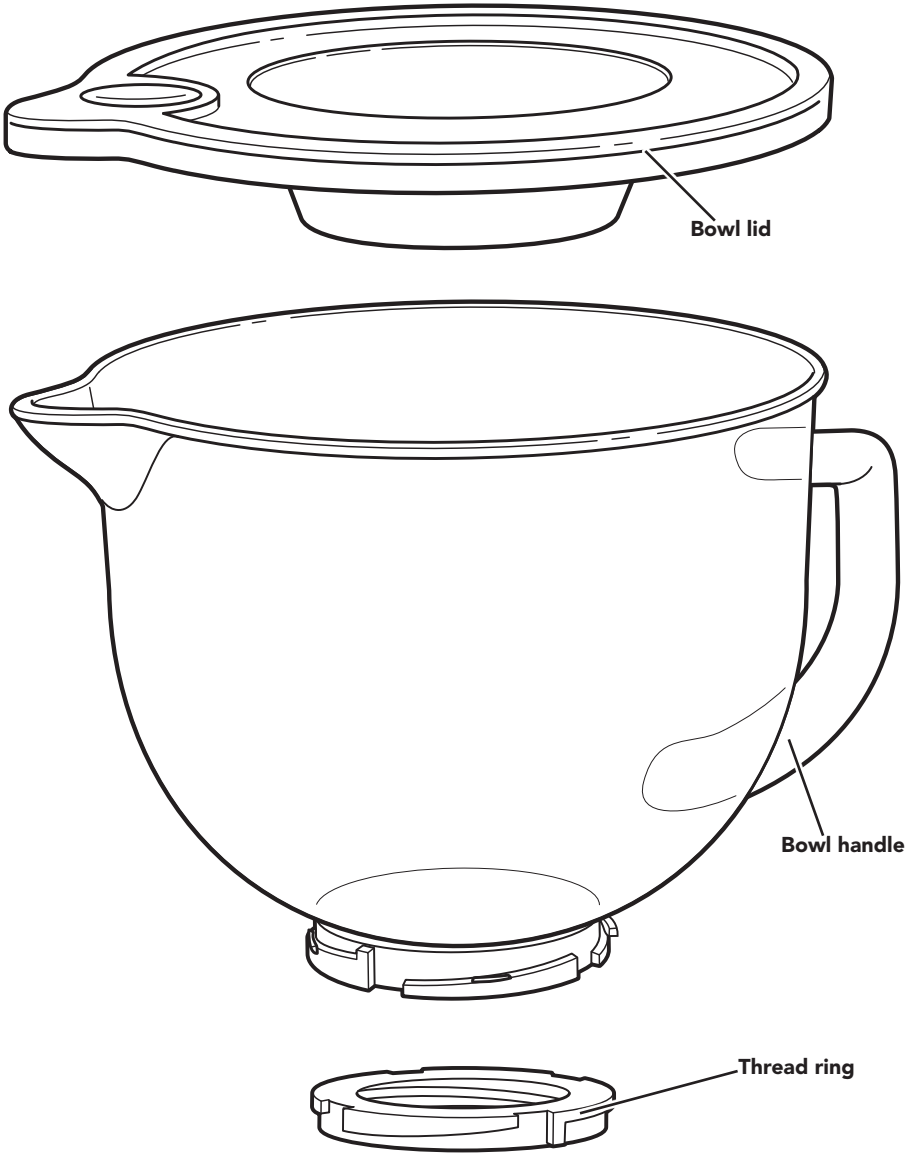

Your safety and the safety of others are very important.

We have provided many important safety messages in this manual and on your appliance. Always read and obey all safety messages.



This is the safety alert symbol.

This symbol alerts you to potential hazards that can kill or hurt you and others.

All safety messages will follow the safety alert symbol and either the word “DANGER” or “WARNING.” These words mean:

 **DANGER**

You can be killed or seriously injured if you don't immediately follow instructions.

 **WARNING**

You can be killed or seriously injured if you don't follow instructions.

All safety messages will tell you what the potential hazard is, tell you how to reduce the chance of injury, and tell you what can happen if the instructions are not followed.

IMPORTANT SAFEGUARDS

When using electrical appliances, basic safety precautions should always be followed, including the following:

1. Read all instructions. Misuse of appliance may result in personal injury.
2. This appliance is not intended for use by persons (including children) with reduced physical, sensory or mental capabilities, or lack of experience and knowledge, unless they have been given supervision or instruction concerning use of the appliance by a person responsible for their safety.
3. This appliance can be used by children aged 8 years and above and persons with reduced physical, sensory, or mental capabilities, or lack of experience and knowledge, if they have been given supervision or instructions concerning use of the appliance in a safe way and understand the hazards involved. Children shall not play with the appliance. Cleaning and user maintenance shall not be made by children without supervision.

GLASS BOWL SAFETY

4. Children should be supervised to ensure that they do not play with the appliance.
5. Never leave the appliance unattended while it is in operation.
6. Turn the appliance off, unplug from outlet, and detach the accessory from appliance before cleaning and when not in use. Turn the appliance off and make sure the motor stops completely before putting on or taking off parts.
7. The use of attachments not recommended or sold by KitchenAid may cause fire, electrical shock, or injury.
8. Do not use the appliance outdoors.
9. Avoid contacting moving parts.
10. Also see the Important Safeguards section included in the Stand Mixer Instructions Manual.
11. This appliance is intended to be used in household and similar applications such as:
 - staff kitchen areas in shops, offices or other working environments;
 - farmhouses;
 - by clients in hotels, motels and other residential type environments;
 - bed and breakfast type environments.

SAVE THESE INSTRUCTIONS

This product is designed for household use only.

WASTE DISPOSAL

Disposal of packing material

The packing material is 100% recyclable and is marked with the recycle symbol

 The various parts of the packing must therefore be disposed of responsibly and in full compliance with local authority regulations governing waste disposal.

USING THE GLASS BOWL

ATTACHING THE GLASS BOWL TO THE STAND MIXER

Before First Use

Your Stand Mixer is individually adjusted at the factory for optimal performance. When using the glass bowl, it may be necessary to readjust the beater-to-bowl clearance. Ensure the thread ring is tight enough to avoid beater-to-bowl hits. When correctly positioned, the handle and pour spout should not touch the pedestal of the mixer. Please refer to the Stand Mixer Instructions Manual for complete instructions on adjusting the beater-to-bowl clearance.

NOTE: This glass bowl is designed to fit several different tilt-head Stand Mixers. It uses a specially designed polymer thread ring between the glass and the metal bowl clamping plate on the mixer to ensure a proper fit. Follow these instructions to attach the glass bowl to your Stand Mixer.

ATTACHING THE THREAD RING TO THE GLASS BOWL

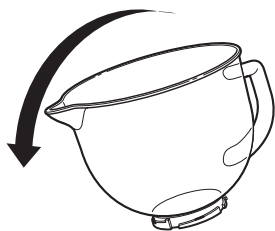

1 Turn the glass bowl over.

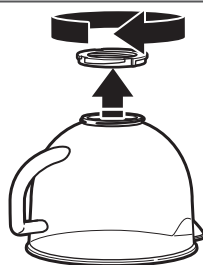

2 Screw the plastic thread ring clockwise onto the bottom threads of the glass bowl until it is firmly attached.

USING THE GLASS BOWL

ATTACHING THE GLASS BOWL TO THE STAND MIXER

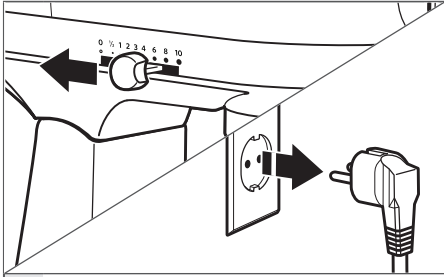

- 1 Turn speed control to "0" (OFF).
Unplug the Stand Mixer and tilt the motor head back.

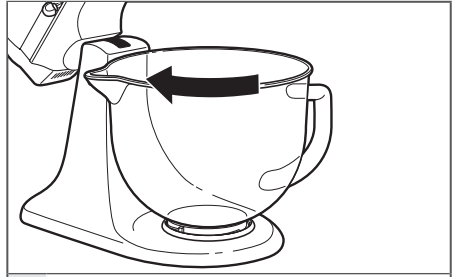

- 2 Place bowl on bowl clamping plate.
Turn bowl gently in a clockwise direction.

REMOVING THE GLASS BOWL FROM THE STAND MIXER

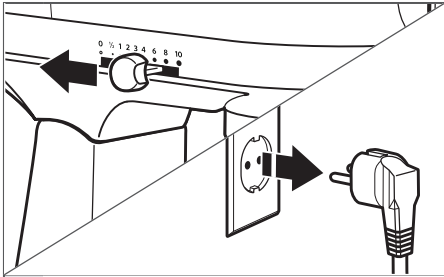

- 1 Turn speed control to "0" (OFF).
Unplug the Stand Mixer and tilt the motor head back.

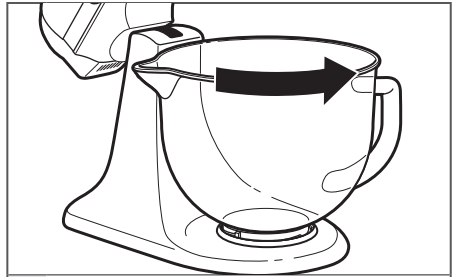

- 2 Turn bowl counterclockwise and lift up to remove.

USING THE GLASS BOWL

REMOVING THE THREAD RING FROM THE GLASS BOWL

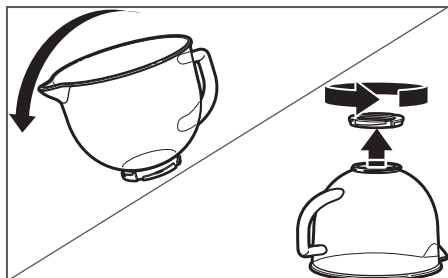

- 1** Turn the bowl over. Rotate the thread ring counterclockwise until it is removed.

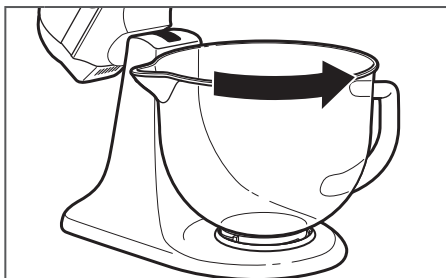

- 2** If the thread ring is too tight, place the bowl back into the bowl clamping plate and turn the bowl counterclockwise until the thread ring is loosened.

TIPS FOR USE

- Remove the thread ring before using the bowl in a microwave oven.
- To avoid product damage, do not use the glass bowl in areas of high heat, such as an oven or on a stove top.
- The markings on the lid that comes with the glass bowl indicate the following: the lid is dishwasher-safe, top rack only, and that the cover is non-sealing.

CARE AND CLEANING

CLEANING THE GLASS BOWL

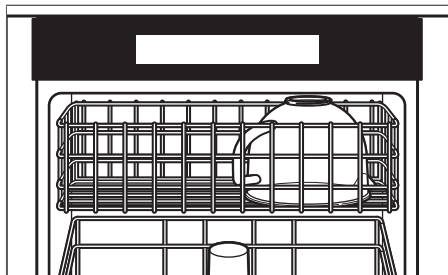

- 1** The bowl and thread ring are dishwasher-safe. The lid is dishwasher-safe, top rack only.

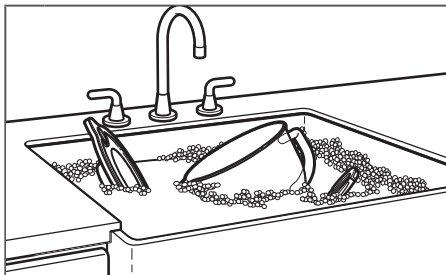

- 2** You can also clean the parts thoroughly in hot, sudsy water and rinse completely before drying.

WARRANTY AND SERVICE

KITCHENAID GLASS BOWL WARRANTY

Length of Warranty:	KitchenAid Will Pay For:	KitchenAid Will Not Pay For:
Europe, Middle East, and Africa: 5KGB Two years full warranty from date of purchase.	The replacement parts and repair labour costs to correct defects in materials or workmanship. Service must be provided by an Authorised KitchenAid Service Centre.	A. Repairs when Glass Bowl is used for operations other than normal household food preparation. B. Damage resulting from accident, alterations, misuse, abuse, or installation/operation not in accordance with local electrical codes.

KITCHENAID DOES NOT ASSUME ANY RESPONSIBILITY FOR INDIRECT DAMAGES.

CUSTOMER SERVICE

In U.K. and Ireland:

For any questions, or to find the nearest Authorised KitchenAid Service Centre, please find our contact details below.

NOTE: All service should be handled locally by an Authorised KitchenAid Service Centre.

Number for general questions:  00800 3810 4026

In other countries:

For all product related questions and after sales matters, please contact your dealer to obtain the name of the nearest Authorised KitchenAid Service/Customer Centre.

For more information, visit our website at:

www.KitchenAid.co.uk
www.KitchenAid.eu

©2017 All rights reserved. KITCHENAID and the design of the stand mixer are trademarks in the U.S. and elsewhere.