



Electric Seasoning Set
CPG130DU

Cuisinart®

Important Safeguards

When using appliances, basic safety precautions should always be followed, including the following:

- 1. This appliance is not intended for use by persons with reduced physical, sensory or mental capabilities, or lack of experience and knowledge, unless they have been given supervision or instruction concerning use of the appliance by a person responsible for their safety.**
- 2. Children should always be supervised to ensure that they do not play with this product.**
- 3. Not for use by children. Keep out of reach of children during and after use.**
- 4. Always inspect the appliance before use for noticeable signs of damage. Do not use if damaged, or if the appliance has been dropped. In the event of damage, or if the appliance develops a fault, contact the Cuisinart Customer Care Line (refer to "UK After Sales Service section" for further information).**

For over 30 years Cuisinart's aim has been to produce the very finest kitchen equipment.

All Cuisinart products are engineered for exceptionally long life, and designed to be easy to use as well as to give excellent performance day after day.

To learn more about our products visit our website www.cuisinart.co.uk

Contents

Product Description 5

Safety Cautions. 6

Instructions for Use 8

A Inserting the batteries 8

B Filling the mill 8

C Assembling the mill 9

D Using the mill 9

E Adjusting the grind 9

Cleaning & Maintenance 10

UK Guarantee & After Sales Service 10

Product Description

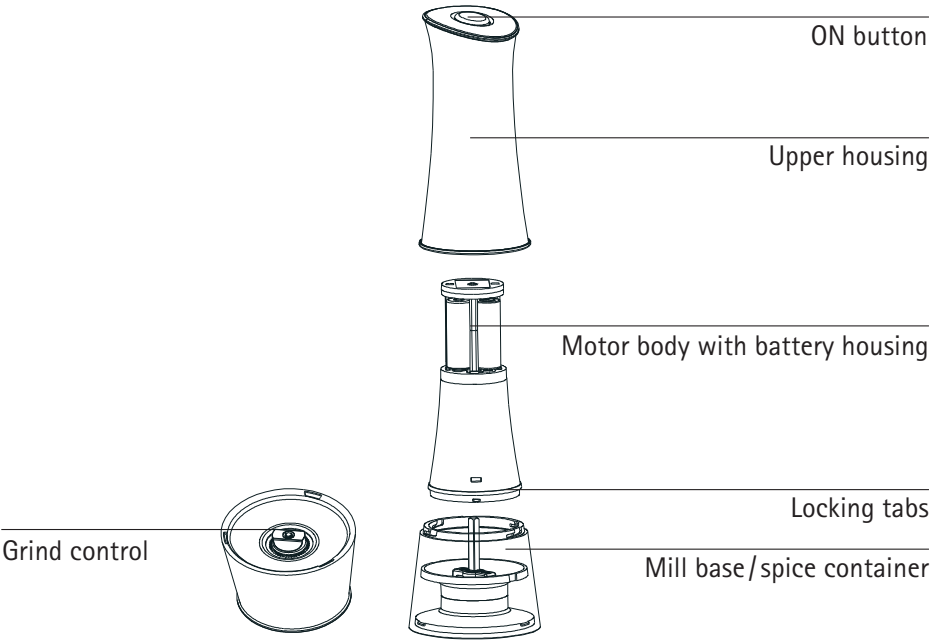

Safety Cautions

Carefully read all the instructions before using the appliance and keep in a safe place for future reference.

Always follow these safety cautions when using this appliance to avoid personal injury or damage to the appliance. This appliance should be used only as described within this instruction book.

- Ensure all packaging materials and any promotional labels or stickers are removed from the Electric Seasoning Set before first use.
- Always inspect the appliance before use for noticeable signs of damage. Do not use if damaged, or if the appliance has been dropped. In the event of damage, or if the appliance develops a fault, contact the Cuisinart Customer Care Line (refer to 'UK After Sales Service' section for further information).
- This appliance is not intended for use by persons with reduced physical, sensory or mental capabilities, or lack of experience and knowledge, unless they have been given supervision or instruction concerning use of the appliance by a person responsible for their safety.
- Not for use by children. Keep out of reach of children during and after use.
- Children should always be supervised to ensure that they do not play with this product.
- Do not use any accessories or attachments with this appliance other than those recommended by Cuisinart.
- Do not immerse the housing base in water or any other liquid or put it in a dishwasher.
- Do not place on a hot surface or near extreme heat.
- Do not place your fingers or any other object into the grinding mechanism.
- Do not touch or operate the Electric Seasoning Set with wet hands.
- Do not press the button for longer than 3 minutes.
- Store the mill in an upright position.
- For indoor use only.
- For domestic use only.
- This appliance should be used only for the preparation of food as described within the instructions for use that accompany it. Please retain these instructions for future reference.
- To avoid injury or possible fire, do not cover the appliance when in use.
- Do not connect this appliance to an external timer or remote control system.
- This appliance complies with the basic requirements of Directives 04/108/EC (Electromagnetic Compatibility) and 06/95/EC (Safety of domestic electrical appliances).



WARNING: Polythene bags over the product or packaging may be dangerous. To avoid danger of suffocation, keep away from babies and children. These bags are not toys.



The symbol  on the product or on its packaging indicates that this product may not be treated as household waste. Instead it should be handed over to an appropriate collection point for the recycling of electrical and electronic equipment.

By ensuring this product is disposed of correctly, you will help prevent potential negative consequences for the environment and human health, which could otherwise be caused by inappropriate waste handling of this product. Make sure that batteries are removed from this appliance before it is disposed of. When the batteries have run down, they must be disposed of safely. Please take them to a recycling centre. If the batteries leak, do not touch them and take them to a recycling centre. For more detailed information about the recycling of this product, please contact your local council office or your household waste disposal service.

Instructions for Use

A Inserting the batteries

- Holding the base in your left hand and the upper housing in the right hand, twist the upper housing clockwise and pull to separate the upper housing from the container base.
- At the base of the upper housing is the battery housing cover which has 2 tabs and the word 'unlock'. Twist the tabs anti-clockwise and remove the battery housing.
- Insert 4 x AA batteries as per the indicators on the battery housing.
- Return the full battery housing to the upper housing.
- Press in and turn the tabs clockwise to lock.

Battery Care:

- We recommend the use of alkaline batteries for a longer life span.
- Do not leave flat batteries in the appliance.
- Remove the batteries when the appliance is not in use for an extended period of time.
- Always replace all 4 AA batteries at the same time.

B Filling the Mill

- Before assembling the mill fill the spice container with peppercorns, rock or sea salt, spices or herbs of your choice.

Note: For the best results use small peppercorns.

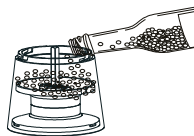

Figure 1

C Assembling the Mill

- After filling the spice container return the upper housing to the spice container by aligning the arrow on the top with the padlock symbols on the base and twist the upper housing anti-clockwise to lock.

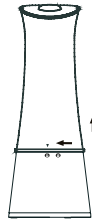

Figure 2

- The product is now ready to be used

D Using the Mill

- Start the grinding process by pressing the 'ON' button on the top of the mill.

Note: Should there be a gradual decline of output when using the appliance there may not be enough peppercorns/salt in the spice container, or there may be some blocked in the mechanism. In this case, gently shake the mill to enable the peppercorns/salt to fall down into the grinder.

E Adjusting the grind

- If you are not happy with the size of the resulting grind, you can adjust the coarseness by twisting the black grind control on the base of the unit.
- The arrow indicates to achieve a coarse grind turn anti-clockwise, or to achieve a fine grind turn clockwise (see figure 3).

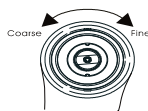

Figure 3

Cleaning & Maintenance

- Never immerse the appliance in water or any other liquid or place in a dishwasher.
- To clean, use a clean, dry cloth. Do not expose the appliance to moisture.
- Do not use detergents to clean it.
- Only wipe the outside with a soft, dry, dust free cloth.

UK Guarantee

This Cuisinart appliance is guaranteed for consumer use for 5 years. This guarantee covers defects under normal use from date of purchase and ceases to be valid in the event of alteration or repairs by unauthorised persons. If the appliance does not perform satisfactorily due to defects in materials or manufacture, it will be repaired or replaced through Conair UK After Sales Service. No responsibility will be accepted for any damage caused in transit. The Conair Group Ltd reserves the right to amend terms and specifications without prior notice.

This guarantee in no way affects your statutory rights.

UK After Sales Service

For further advice on using the appliance, contact the Conair Customer Care Line on 0870 240 6902 (09:00 to 17:00 Monday to Friday) or email your enquiry to support@cuisinart.co.uk

If you should need to return your appliance to us please send it to the following address:

Customer Care Centre,
Conair Logistics
Unit 4
Revolution Park
Buckshaw Avenue
Buckshaw Village
Chorley
PR7 7DW

Please enclose your name and address, together with a copy of proof of purchase and details of the fault.

www.cuisinart.co.uk